

ADAMS COUNTY

CORNER NO. 574

Survey Monument Record

SECTION 4

TYPE OF MONUMENT: Harrison standard

TOWN 20

STATE PLANE COORDINATES: N _____

RANGE 6

E _____

ELEVATION — M.S.L. DATUM: _____

THETA ANGLE: _____

FIELD BOOK: _____ PAGE _____

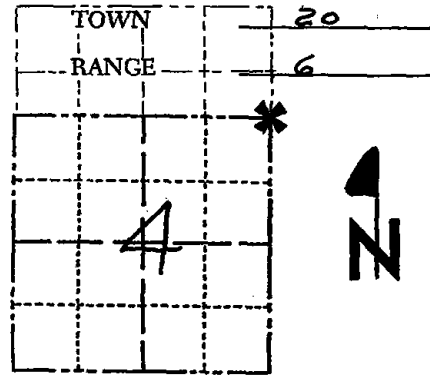

LOCATION
(Indicated by 'X')

SEAL:



BASIS FOR MONUMENT LOCATION

(Use reverse side if necessary)

Show info such as: History of corner, with reference to Vol. and pg, dates, surveyor; exact description of monument replaced; if location computed, by taped or EDM traverse; landowner remarks, etc.

Set Corner proportionately and on line from adjacent corners. Excavation and extensive search yielded no conclusive evidence.

Mon. O.K. - 1' BELOW SURFACE 3-23-79 R.N.-OW

see the reverse side for updated map 5-11-84

CERTIFIED CORRECT:

Dale C. Hagen
Registered Land Surveyor

DATE: 10-24-74

TIE SKETCH

(Show at least four ties)

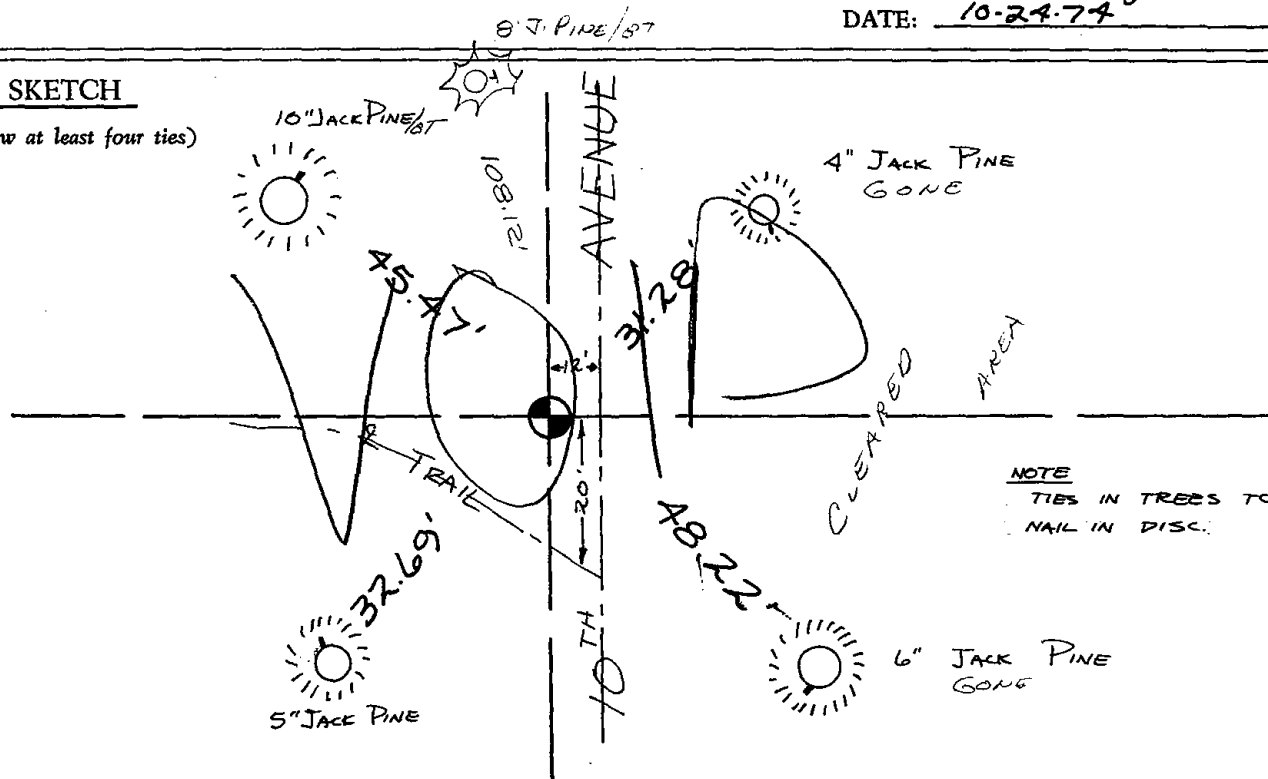

NOTE
TIES IN TREES TO
NAIL IN DISC.

6" WHITE PINE '09
NOT BLAZED - GONE
W. PINE IN VICINITY

15" J. Pine/
DND SIGN BT

DND SIGN
10" J. Pine/BT

45.47'
DND

108.12'

10TH
RUE.

PINE PLANTATION

Cleared Area

32.05' Steel Post DISTURBED

E TRAIL

20'

56'-9"
56" J. PINE
24 '09
5" J. Pine
GONE 99

Cleared Area

64.8

12'±

26' 5" JACK PINE '09



- Map updated 5-11-84 SS-DK
- OK. 2-23-89 SS
- 1-GONE 3-7-99 JG-GR
- OK 2-16-99-JG-SS
- OK, 2-27-04-JG
- 3 NEW TREES 3-13-09 SS