

01 SECTION 20 TOWN 07 RANGE

# ADAMS COUNTY

COUNTY CORNER NO: 20  
 ROMPORTOL ID: 42007012000

## PUBLIC LAND SURVEY MONUMENT RECORD

TYPE OF MONUMENT: HARRISON WITH TOP BROKE OFF  
 ADAMS COUNTY COORDINATES, NAD 83 (2007)

N. 317048.961

E. 588431.702

ELEVATION-      DATUM     

FIELD WORK DATE: 12/28/2016

### BASIS FOR MONUMENT LOCATION

1982 - PLS 878 DID NOT FIND ANY REMAINS OF ANY REMONUMENTATON AND FOUND NO RESURVEYS OF RECORD. SET A HARRISON ON LINE AT A PRORATED DISTANCE BETWEEN THE SE AND NE CORNERS OF SECTION 1.

2017 - PLS 2994 FOUND EXISTING HARRISON 10 INCHES BELOW THE SURFACE, 2 EXISTING TIES AND 2 WITNESS TREES. THE HARRISON AGREES WITH EXISTING TIES AND WITNESS TREES. ACCEPTED HARRISON AND SET 2 NEW TIES.

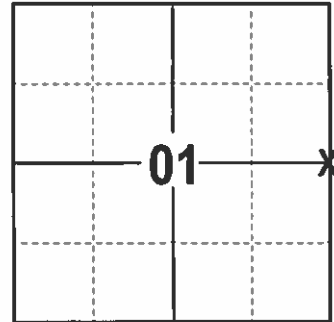

**LOCATION**  
(INDICATE CORNER BY "X")

SEAL:

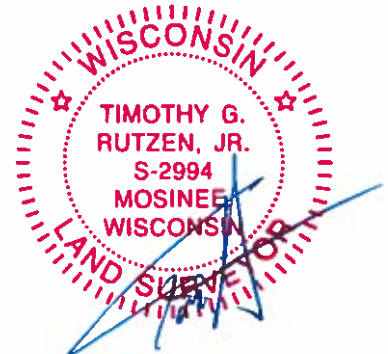

DATA SHOWN HERE ON THIS TIE SHEET IS CORRECT AND COMPLETE TO THE BEST OF MY KNOWLEDGE AND BELIEF.

PROFESSIONAL LAND SURVEYOR

DATE 2/9/17

### - TIE SKETCH

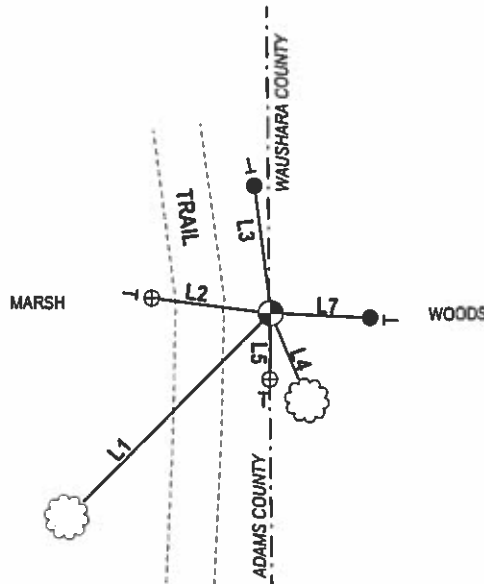
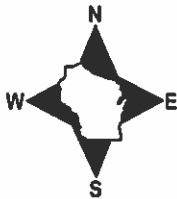

- 3/4" X 18" IRON REBAR SET, 1.50#/FT
- ⊕ 2" OD IRON PIPE WITH CAP FOUND
- ⊙ HARRISON FOUND
- VINYL "T" POST
- ☼ WITNESS TREE FOUND

LINE	BEARING	DISTANCE
L1	N 45°07' E	60.5±
L2	N 82°40'08" W	25.08'
L3	N 07°13'27" W	26.67'
L4	S 22°27' E	19.5±
L5	S 01°14'06" W	13.73'
L7	S 87°19'14" E	20.77'

# Government Land Corner Certificate

ADAMS County  
 TYPE OF MONUMENT: HARRISON  
 STATE PLANE COORDINATES: N \_\_\_\_\_  
 E \_\_\_\_\_  
 ELEVATION — M.S.L. DATUM: \_\_\_\_\_  
 THETA ANGLE: \_\_\_\_\_  
 FIELD BOOK: 88 PAGE 119  
 DRAWN BY: S.J.H.

CORNER NO. 20  
 SECTION 1  
 TOWN 20  
 RANGE 7

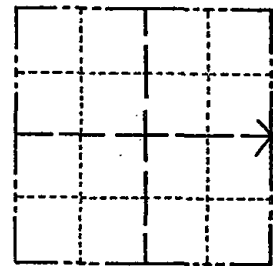

LOCATION  
(Indicated by 'X')

## BASIS FOR MONUMENT LOCATION

Show info such as: History of corner, with reference to Vol. and pg., dates, surveyor; exact description of monument replaced; if location computed, by taped or EDM traverse; landowner remarks, etc. (Use reverse side if necessary)

Set corner on line at prorated distance between SE corner of Section 1 and NE corner of Section 1. No resurveys of record. Could find no remains of any remonumentation.

SEAL:



DATA SHOWN HERE ON CERTIFIED CORRECT:

*Anthony B. Kiedrowski*  
 Registered Land Surveyor

DATE: 5-9-82

## TIE SKETCH

Show at least four ties, also fence lines, roads, topo, size and type of witness trees and if off road - best way to arrive at corner.

