

ADAMS COUNTY

Survey Monument Record

TYPE OF MONUMENT: MEANDER CORNER, HARRISON BLINKLINE

STATE PLANE COORDINATES: N _____

E _____

ELEVATION — M.S.L. DATUM: _____

THETA ANGLE: _____

FIELD BOOK: _____ PAGE _____

CORNER NO. 994 ⁴³

SECTION 17

TOWN 14 N

RANGE 6 E

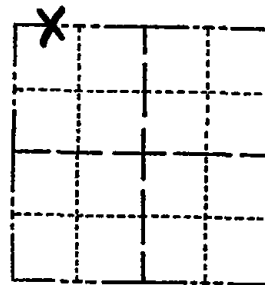

LOCATION
(Indicated by 'X')

SEAL:



CERTIFIED CORRECT:

Frederic W. Zietlow
Registered Land Surveyor

DATE: JUNE 8, 1976

BASIS FOR MONUMENT LOCATION

(Use reverse side if necessary)

Show info such as: History of corner, with reference to Vol. and pg, dates, surveyor; exact description of monument replaced; if location computed, by taped or EDM traverse; landowner remarks, etc.

CHECKED ADAMS COUNTY SURVEY RECORDS FOR RESURVEYS & NONE WERE ON FILE. RAN A RANDOM TRAVERSE TO THE WISCONSIN RIVER AND FOUND A 2" X 1/8" IRON PIPE FLUSH WITH THE GROUND SET BY PERSONS UNKNOWN, ACCEPTED AS BEST AVAILABLE EVIDENCE & MONUMENTED SAME.

CORNER OK 12-21-81 SK-DW

ALL OK 3-25-91 GR-JG

" " 4-24-96 JG-SS

" " 3-07-01 - JG-MH

1-GONE, 1-NEW, 1-14-06 - JG

TIE SKETCH

OK 12-19-11 MS

(Show at least four ties)

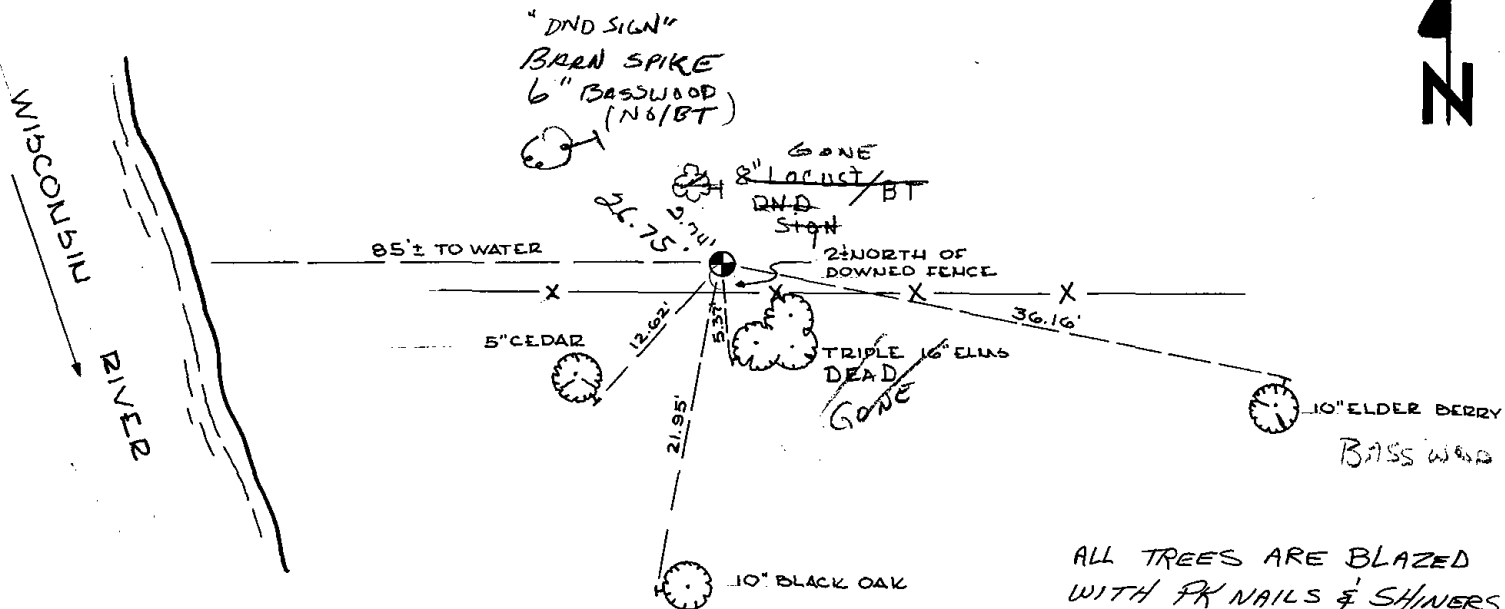

ALL TREES ARE BLAZED WITH PK NAILS & SHINERS