

Government Land Corner Certificate

MC #11

ADAMS _____ County

CORNER NO. 17

SECTION 3

TOWN 15

RANGE 5

TYPE OF MONUMENT: 1 1/2" x 30" Iron Rod

STATE PLANE COORDINATES: N _____
E _____

ELEVATION — M.S.L. DATUM: _____

THETA ANGLE: _____

FIELD BOOK: SS 5 PAGE 94

DRAWN BY: _____

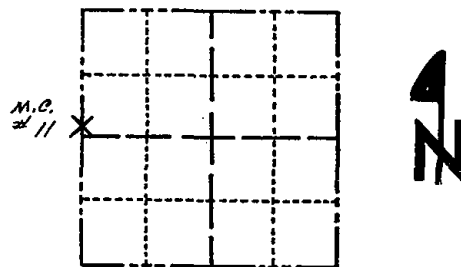

LOCATION
(Indicated by 'X')

SEAL:



DATA SHOWN HERE ON
CERTIFIED CORRECT:

Gregory P. Rhinehart
Registered Land Surveyor

DATE: 1-3-82

BASIS FOR MONUMENT LOCATION

Show info such as: History of corner, with reference to Vol. and pg., dates, surveyor; exact description of monument replaced; if location computed, by taped or EDM traverse; landowner remarks, etc. (Use reverse side if necessary)

Extended the section line as determined by Springville Assessor's Plat No. 3 to record distance at river bank. Thorough search yielded no evidence of any previous monumentation. 1 1/2" x 30" Iron Rod set at record distance on section line as determined by Assessor's Plat.

TIE SKETCH

Show at least four ties, also fence lines, roads, topo, size and type of witness trees and if off road - best way to arrive at corner.

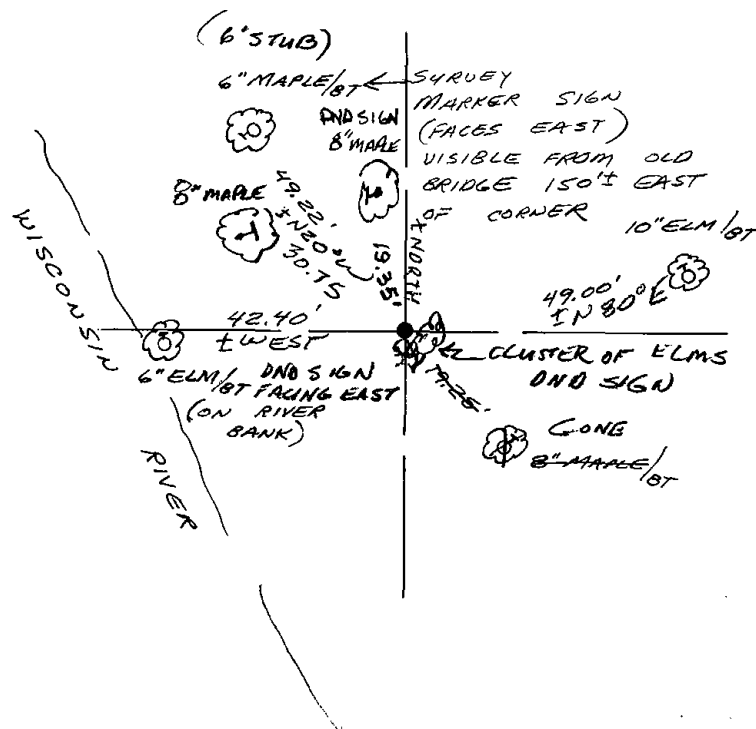

MAINTENANCE RECORD

Date	Init.	Remarks
1-28-86	GR-SS	OK
1-15-96	JG-SS	OK - TREES REBUZED
2-2-01	JG-SS	2-NEW, 1-GONE
4-24-06	JG	OK
1-07-11	SS	OK