

PUBLIC LAND SURVEY MONUMENT RECORD

TYPE OF MONUMENT: HARRISON
 ADAMS COUNTY COORDINATES, NAD 83 (2007)

N. 143495.748

E. 562654.653

ELEVATION- _____ DATUM _____

FIELD WORK DATE: 04/07/2021

BASIS FOR MONUMENT LOCATION

1972 - PLS 981 FOUND ANGLE IRON AND REPLACED WITH HARRISON MONUMENT.

2021 - PLS 2675 FOUND HARRISON MONUMENT FLUSH WITH GROUND SURFACE AND 3 WITNESS TREES. MONUMENT AGREES WITH ALL WITNESSES. ACCEPTED HARRISON MONUMENT AS THE CORNER LOCATION. SET 4 NEW TIES AND MEASURED TO THE EXISTING WITNESS TREES.

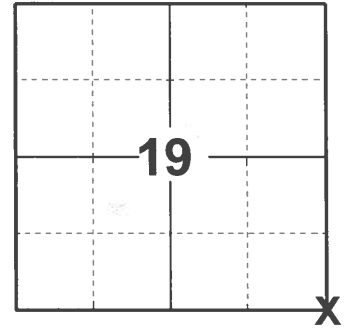

LOCATION

(INDICATE CORNER BY "X")

SEAL:



DATA SHOWN HERE ON THIS TIE SHEET IS CORRECT AND COMPLETE TO THE BEST OF MY KNOWLEDGE AND BELIEF.

PROFESSIONAL LAND SURVEYOR

DATE 5/19/21

TIE SKETCH

NOTE: CORNER LANDS 220± EAST OF 5TH LANE.

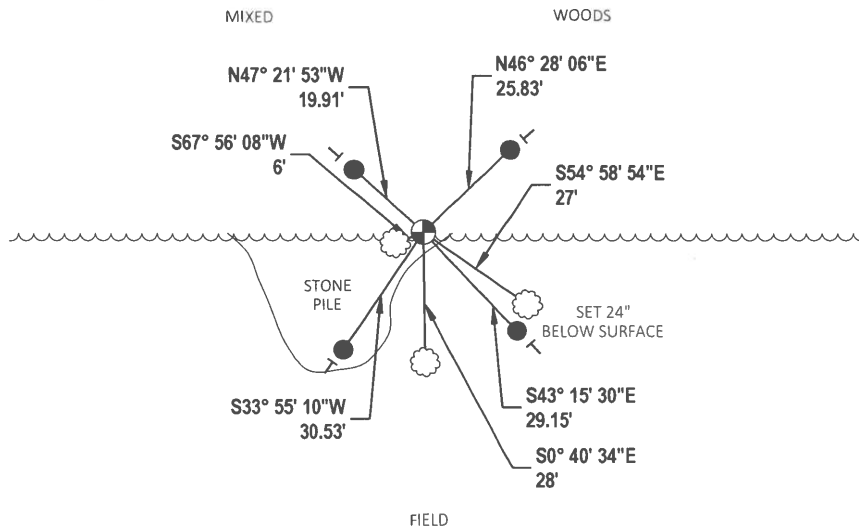
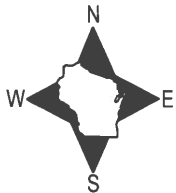

- SET 3/4" x 18" IRON REBAR, 1.50#/FT
- ⊕ FOUND HARRISON MONUMENT
- ┆ VINYL "T" POST
- ☼ WITNESS TREE

ADAMS COUNTY

Survey Monument Record

TYPE OF MONUMENT: "30" HARRISON
 STATE PLANE COORDINATES: N _____
 E _____
 ELEVATION — M.S.L. DATUM: _____
 THETA ANGLE: _____
 FIELD BOOK: 106 PAGE _____

CORNER NO. 117
 SECTION 30
 TOWN 15
 RANGE 7

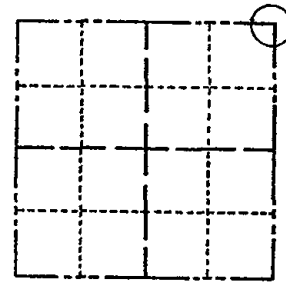

LOCATION
(Indicated by 'X')

SEAL: _____

BASIS FOR MONUMENT LOCATION

(Use reverse side if necessary)

Show info such as: History of corner, with reference to Vol. and pg, dates, surveyor; exact description of monument replaced; if location computed, by taped or EDM traverse; landowner remarks, etc.

Found angle-iron and set monument

May 7, 1972

Sam T. Mullen R.L.S. S-981

Corner O.S. - trees scribed "37" 5-20-76 G.P.S.S

MAINTENANCE RECORD

Date	Init.	Remarks
12-29-81	TH-NJ	MON - O.K.
2-3-86	GR-SS	OK
6-7-91	JS-SS	1 NEW TIE
11-29-95	SS	OK
2-16-01	JG	OK
8-8-06	JG	OK

CERTIFIED CORRECT:

Registered Land Surveyor

DATE: _____

TIE SKETCH

7-15-11 SS 2 NEW

(Show at least four ties)

