

## PUBLIC LAND SURVEY MONUMENT RECORD

TYPE OF MONUMENT: ALUMINUM CAP IN CONCRETE  
 ADAMS COUNTY COORDINATES, NAD 83 (2007)

N. 191113.711

E. 525811.805

ELEVATION-      DATUM     

FIELD WORK DATE: 11/13/2017

### BASIS FOR MONUMENT LOCATION

1972 - PLS 878 FOUND A 2" CAPPED PIPE SET IN CONCRETE AT THE CORNER LOCATION AND RE-TIED.

2017 - PLS 2994 FOUND AN ALUMINUM CAP IN CONCRETE 2" BELOW THE GROUND SURFACE AND 2 WITNESSES. THE MONUMENT AGREES WITH THE EXISTING WITNESSES. ACCEPTED THE ALUMINUM CAP IN CONCRETE AS THE CORNER LOCATION. SET 4 NEW TIES AND MEASURED TO THE TIES AND WITNESSES.

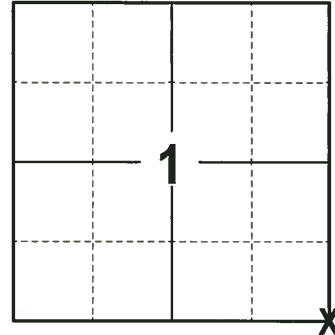

**LOCATION**  
 (INDICATE CORNER BY "X")

SEAL:



DATA SHOWN HERE ON THIS TIE SHEET IS CORRECT AND COMPLETE TO THE BEST OF MY KNOWLEDGE AND BELIEF.

PROFESSIONAL LAND SURVEYOR

DATE 12-4-17

### - TIE SKETCH

NOTE: THE CORNER FALLS 325± EAST OF THE CENTERLINE OF 14TH COURT AND 13± NORTH OF THE POWER LINE.

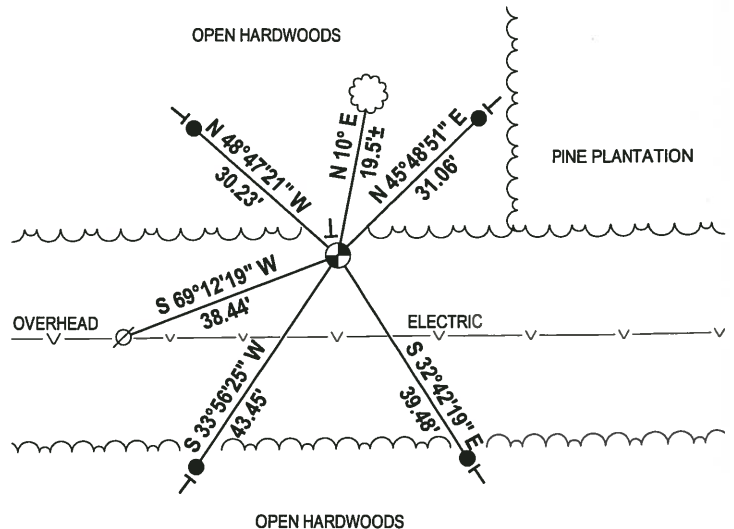
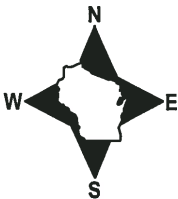

- 3/4" x 18" IRON REBAR SET, 1.50#/FT
- ⊙ ALUMINUM CAP IN CONCRETE FOUND
- ⊗ WITNESS POWER POLE FOUND
- ┌ VINYL "T" POST
- ☼ WITNESS TREE FOUND

ADAMS COUNTY

Survey Monument Record

TYPE OF MONUMENT: Concrete monument that is stamped as the section corner

STATE PLANE COORDINATES: N \_\_\_\_\_ E \_\_\_\_\_

ELEVATION — M.S.L. DATUM: \_\_\_\_\_

THETA ANGLE: \_\_\_\_\_

FIELD BOOK: 103? PAGE ?

CORNER NO. 172

SECTION 1

TOWN 16

RANGE 5

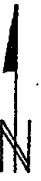
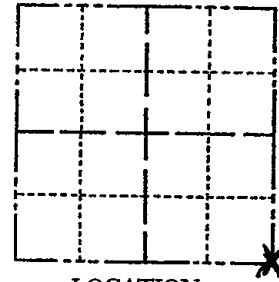

LOCATION (Indicated by 'X')

SEAL:



BASIS FOR MONUMENT LOCATION

(Use reverse side if necessary)

Show info such as: History of corner, with reference to Vol. and pg, dates, surveyor; exact description of monument replaced; if location computed, by taped or EDM traverse; landowner remarks, etc.

Found this concrete monument - 2" Capped pipe

August 4, 1972

Anthony B Kiedrowski R.L.S. 878

Corner & ties o.k. 8-8-75

COR OK 10/6/80 KV-SK

ALL OK 7-9-85 D.K.

OK 2-15-90 KZ-GR

ALL OK 3/10/95 JG-CR

ALL OK 5/9/00 - JG

CERTIFIED CORRECT:

Anthony B. Kiedrowski  
Registered Land Surveyor

DATE: 1-30-73

TIE SKETCH ALL OK 12/20/05 - JG  
ADD 1 TIE 1-4-11 SS

(Show at least four ties)

