

## PUBLIC LAND SURVEY MONUMENT RECORD

TYPE OF MONUMENT: HARRISON  
 ADAMS COUNTY COORDINATES, NAD 83 (2007)

N. 183274.086

E. 520533.334

ELEVATION- - - - - DATUM - - - - -

FIELD WORK DATE: 01/19/2021

### BASIS FOR MONUMENT LOCATION

1977 - PLS 1103 RAN EDM/T2 TRAVERSE AROUND SECTION 14 TO DETERMINE SEARCH AREAS. INITIALLY TAPED 2640'± SOUTH FROM NORTHEAST CORNER ALONG EXTENSION OF FENCELINE AND FOUND 2" DIAMETER BY 4' A LONG DRIVEN POINTED POST SET BY COUNTY SURVEYOR A.J. BARRETT IN 1902 (VOL. 1, PAGE 1 OF COUNTY SURVEYOR RECORDS AND ON PAGES 5-13 OF BOOK 3 OF FIELD NOTES. BARRETT SAYS THAT HE COULDN'T FIND THE ORIGINAL CORNER, AND SIMPLY SET POST. MONUMENTED WITH 2"X30" IRON PIPE. APPROXIMATELY 200 FEET EAST, FOUND REMAINS OF ORIGINAL POST, AND STUMP OF ORIGINAL TAMARACK BEARING TREE (98" TAMARACK, S68-1/4°W, 41 LINKS). REMONUMENTED CORNER WITH HARRISON MONUMENT ON 12-06-1976.

2021 - PLS 2675 FOUND HARRISON MONUMENT 4"± BELOW THE SWAMP SURFACE AND DID NOT RECOVER ANY TIES OR WITNESSES. ACCEPTED THE HARRISON AS THE CORNER. SET 4 NEW TIES.

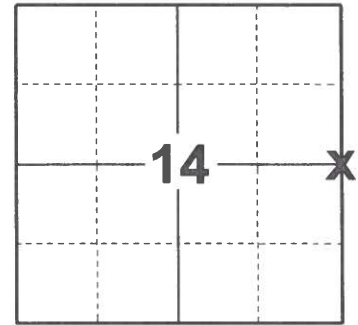

**LOCATION**  
 (INDICATE CORNER BY "X")

SEAL:

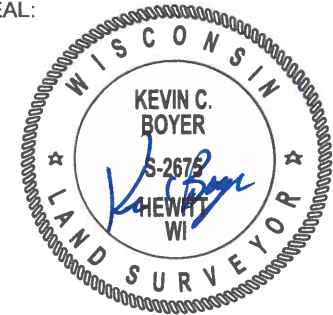

DATA SHOWN HERE ON THIS TIE SHEET IS CORRECT AND COMPLETE TO THE BEST OF MY KNOWLEDGE AND BELIEF.

PROFESSIONAL LAND SURVEYOR

DATE 2/23/2021

### TIE SKETCH

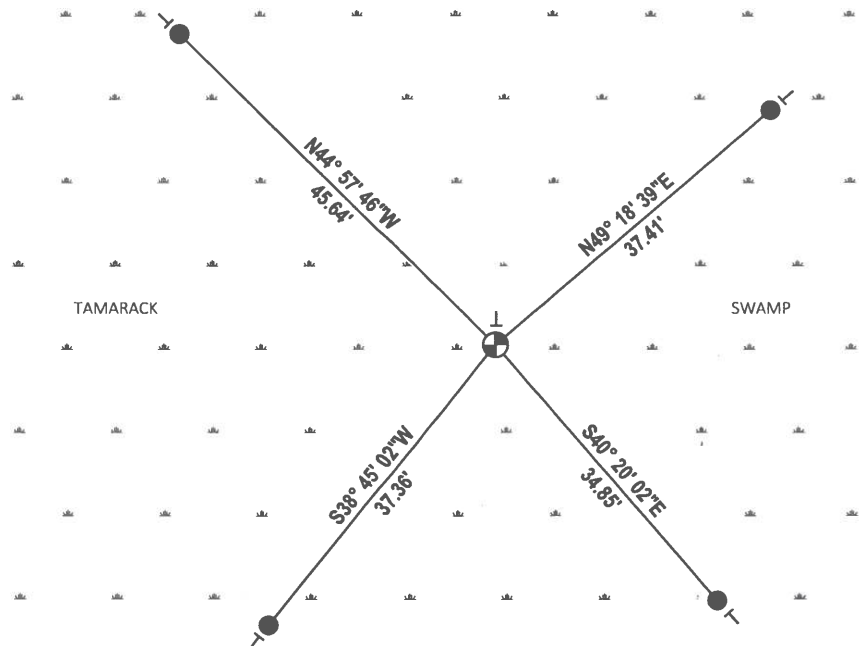

- SET 3/4" x 18" IRON REBAR, 1.50#/FT
- ⊕ FOUND HARRISON MONUMENT
- ┊ VINYL "T" POST

ADAMS COUNTY

Survey Monument Record

TYPE OF MONUMENT: Harrison

STATE PLANE COORDINATES: N \_\_\_\_\_

E \_\_\_\_\_

ELEVATION — M.S.L. DATUM: \_\_\_\_\_

THETA ANGLE: \_\_\_\_\_

FIELD BOOK: 39 PAGE 45

CORNER NO. 59

SECTION 14

TOWN 16 N

RANGE 5 E

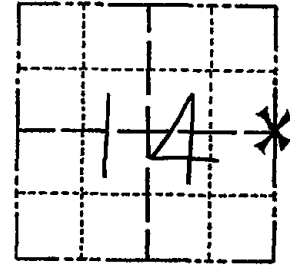

LOCATION (Indicated by 'X')

SEAL:

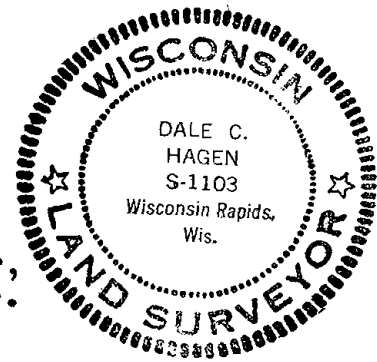

BASIS FOR MONUMENT LOCATION

(Use reverse side if necessary)

Show info such as: History of corner, with reference to Vol. and pg, dates, surveyor; exact description of monument replaced; if location computed, by taped or EDM traverse; landowner remarks, etc.

Ran EDM/T2 traverse around Section 14 to determine search areas.

Initially taped 2540'± South from Northeast corner along extension of fence line and found 2" diameter by 4' long driven pointed post set by County Surveyor A.J. Barrett in 1902 (Vol 1, Page 1 of County Surveyor Records and on Pages 5-13 of Book #3 of Fieldnotes). Barrett says that he couldn't find the original corner, and simply set post. Monumented with 2"x30" Iron Pipe.

Approximately 200 feet East, found remains of Original Post, and stump of original tamarack bearing tree (8" Tamarack, S 68 1/4 W, 41 links).

Remonumented corner with Harrison monument on 12-6-76.

ENTER ALONG TRAIL BY FOSELD. GO SOUTH ALONG TRAIL. TAKE TRAIL TO RIGHT, WALK 2600' SOUTH THROUGH SWAMP.

CERTIFIED CORRECT:

Dale C Hagen

Registered Land Surveyor

DATE: Jan. 24, 1977

TIE SKETCH

WHERE TRAIL CONTINUES

S. E. EARLY - COMES

(Show at least four ties) AROUND ON RIDGE ± 160' SOUTH OF CORNER

NOTE

Ties in trees to nail in disc.

8" White Pine/BT

SURVEY MARKER SIGN ON 6' TALL MAPLE POST AT CORNER - SIGN FACES SOUTH

MAINTENANCE RECORD ON BACK.

12" White Pine/BT

Stump of original tamarac bearing tree (Blaze faces corner)

20" White Pine/BT

10" Black Oak/BT

BLAZES N & S SIDES RIDGE

MON. & TIES OK. DISREGARD BT'S WEST OF BRUSH LINE, CORNER ±175' EAST OF LINE.

RN-SK 1/15/81

GR-SS 11-85

OK GR-KZ 1-9-90

7-13-90 M. CARLSON - OK

12-01-10 OK SS