

22
SECTION

16
TOWN

05
RANGE

ADAMS COUNTY

COUNTY CORNER NO: 89

ROMPORTOL ID: 41605220000

PUBLIC LAND SURVEY MONUMENT RECORD

TYPE OF MONUMENT: HARRISON (BROKEN-TOP)
ADAMS COUNTY COORDINATES, NAD 83 (2007)

N. 175282.291

E. 515260.374

ELEVATION- - - - DATUM - - - -

FIELD WORK DATE: 01/21/2021

BASIS FOR MONUMENT LOCATION

1977 - PLS 1103 RAN EDM/T2 TRAVERSE AROUND SECTION 27 AND PARTS OF ADJOINING SECTIONS TO DETERMINE SEARCH AREA FOR INVESTIGATION. AN INVESTIGATION YIELD NO EVIDENCE OF THE CORNER OR ANY WITNESSES TREES. COULD FIND NO EVIDENCE OF ANY REMONUMENTATION OF THIS CORNER. RELOCATED CORNER BY DOUBLING OVER DISTANCE BETWEEN NW AND N1/4 CORNER OF SECTION 27 AND SETTING CORNER ON THE EXTENSION OF THE STRAIGHT PORTION OF THE FENCE WHICH RUNS EASTERLY FROM THE NORTH QUARTER CORNER. DISTANCE TO EAST QUARTER CORNER FIT ORIGINAL DIMENSIONS VERY WELL (2640.46).

2021 -PLS 2675 FOUND A HARRISON (BROKEN-TOP) MONUMENT 6"± BELOW THE GROUND AND DID NOT FIND ANY EXISTING TIES OR WITNESSES. ACCEPTED THE HARRISON (BROKEN-TOP) AS THE CORNER. SET 4 NEW TIES.

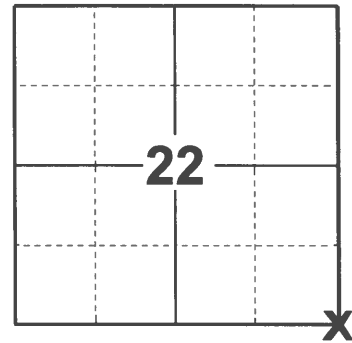

LOCATION

(INDICATE CORNER BY "X")

SEAL:

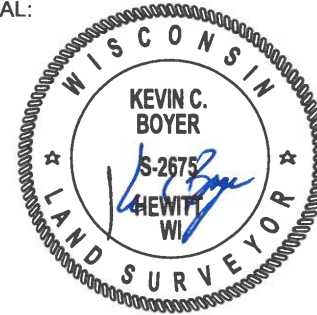

DATA SHOWN HERE ON THIS TIE SHEET IS CORRECT AND COMPLETE TO THE BEST OF MY KNOWLEDGE AND BELIEF.

PROFESSIONAL LAND SURVEYOR

DATE 3/3/2021

TIE SKETCH

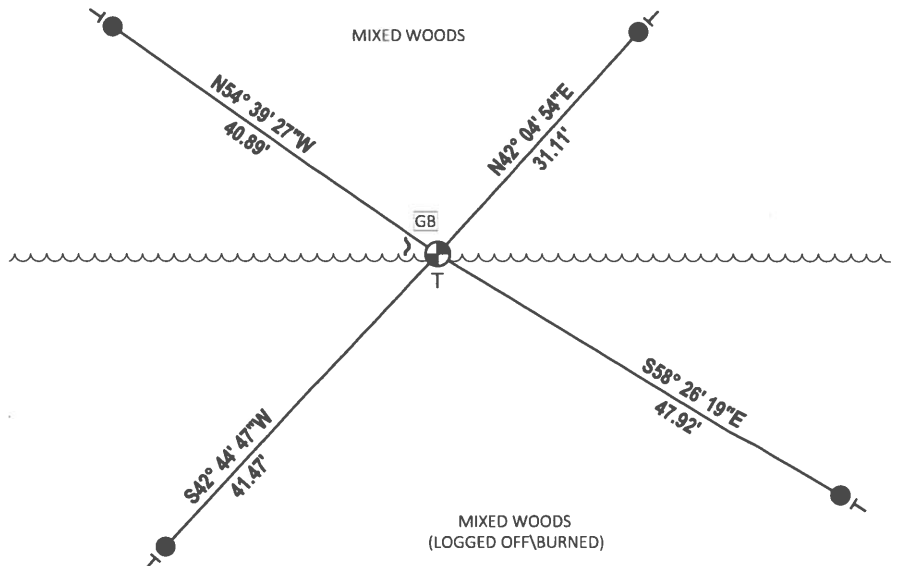
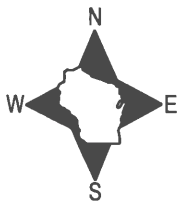

- SET 3/4" x 18" IRON REBAR, 1.50#/FT
- ⊕ FOUND HARRISON (BROKEN-TOP) MONUMENT
- ↘ STEEL FENCE POST
- VINYL "T" POST
- GB GROUND BLIND

Government Land Corner Certificate

ADAMS County

CORNER NO. 89
 SECTION 27
 TOWN 16 N
 RANGE 5 E

TYPE OF MONUMENT: HARRISON
 STATE PLANE COORDINATES: N _____
 E _____
 ELEVATION — M.S.L. DATUM: _____
 THETA ANGLE: _____
 FIELD BOOK: 58 PAGE _____
 DRAWN BY: D.C.H.

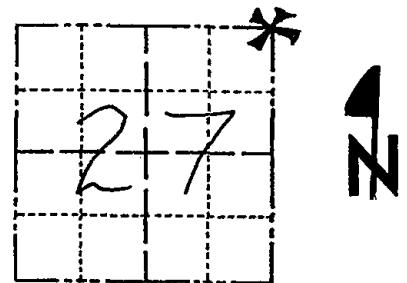

LOCATION
(Indicated by 'X')

BASIS FOR MONUMENT LOCATION

Show info such as: History of corner, with reference to Vol. and pg., dates, surveyor; exact description of monument replaced; if location computed, by taped or EDM traverse; landowner remarks, etc. (Use reverse side if necessary)

Ran EDM/T2 traverse around Section 27 and parts of adjoining sections to determine search area for investigation.

An investigation yielded no evidence of the corner or any witness trees. Could find no evidence of any remonumentation of this corner.

Relocated corner by doubling over distance between NW and N $\frac{1}{4}$ corners of Section 27 and setting corner on the extension of the straight portion of the fence which runs Easterly from the North Quarter corner. Distance to East Quarter corner fits original dimensions very well (2640.46).

SEAL:

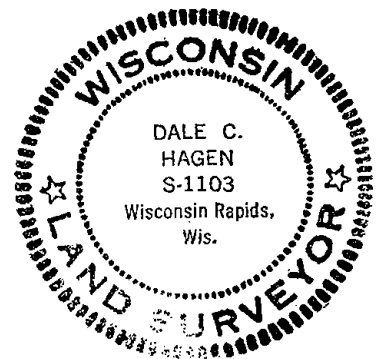

DATA SHOWN HERE ON
CERTIFIED CORRECT:

Dale C. Hagen
Registered Land Surveyor

DATE: 12-6-77

TIE SKETCH

Show at least four ties, also fence lines, roads, topo, size and type of witness trees' and if off road - best way to arrive at corner.

NOTE:

Ties in trees to nail in disc.

(3) NATURE CONSERVATION
SIGNS ON 10" BLK OAK
4'± NORTH OF CORNER

SURVEY MARKER SIGN
ON 4" BLACK OAK "GONE"
IMMEDIATELY WEST
OF HARRISON

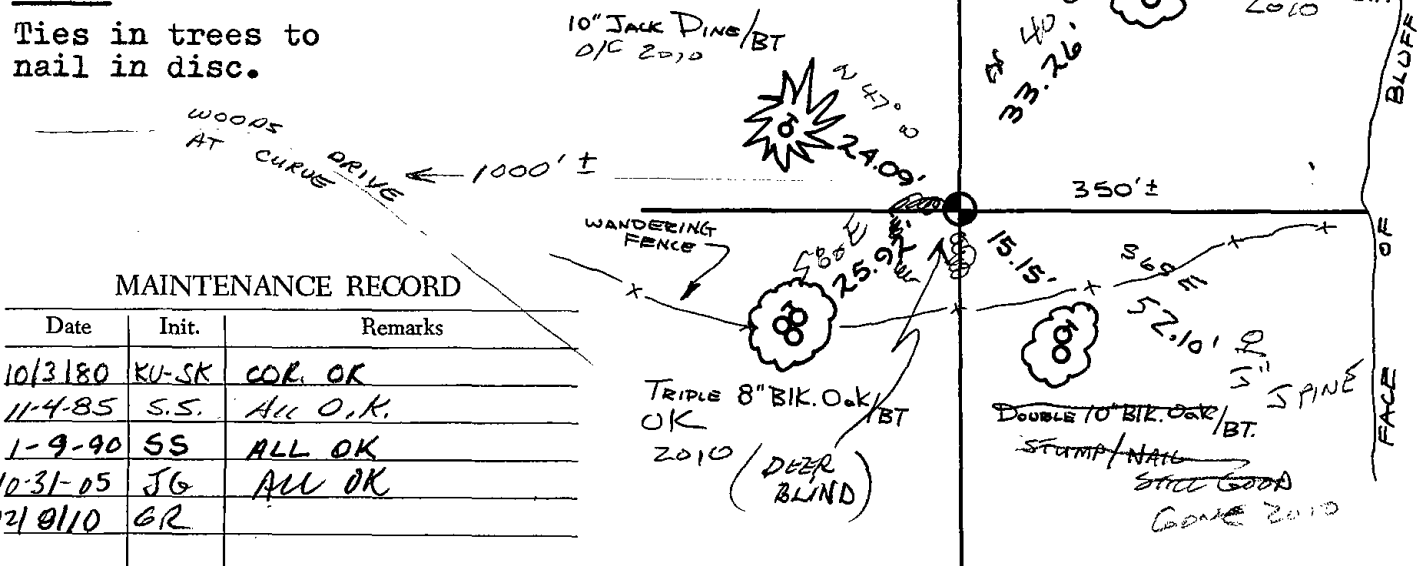

MAINTENANCE RECORD

Date	Init.	Remarks
10/3/80	KU-SK	COR. OK
11-4-85	S.S.	ALL O.K.
1-9-90	SS	ALL OK
12-31-05	JG	ALL OK
12/0/10	GR	