

ADAMS COUNTY

Survey Monument Record

TYPE OF MONUMENT: 1" IRON PIPE

STATE PLANE COORDINATES: N _____

E _____

ELEVATION — M.S.L. DATUM: _____

THETA ANGLE: _____

FIELD BOOK: 27 PAGE 16

CORNER NO. 348 (49)

SECTION 15

TOWN 16N

RANGE 6E

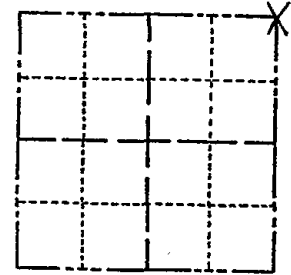

LOCATION
(Indicated by 'X')

SEAL:

BASIS FOR MONUMENT LOCATION

(Use reverse side if necessary)

Show info such as: History of corner, with reference to Vol. and pg, dates, surveyor; exact description of monument replaced; if location computed, by taped or EDM traverse; landowner remarks, etc.

Location determined by computed coordinates from an extensive traverse connecting all existing monuments and evidence in all of Sec. 15. Point falls within the intersection of 9th Ave. and Edgewood Ave. 1 inch iron pipe set.
Dog with backhoe - found nothing



Anthony Kiedrowski, Co. Surveyor, present.

Cor. O.K. 10-2-75 SS

COR OK 10/15/80 KV-RN

ALL OK 7-15-85 DK

CERTIFIED CORRECT:

R. K. Saylor
Registered Land Surveyor

DATE: 1/15/74

TIE SKETCH

(Show at least four ties)

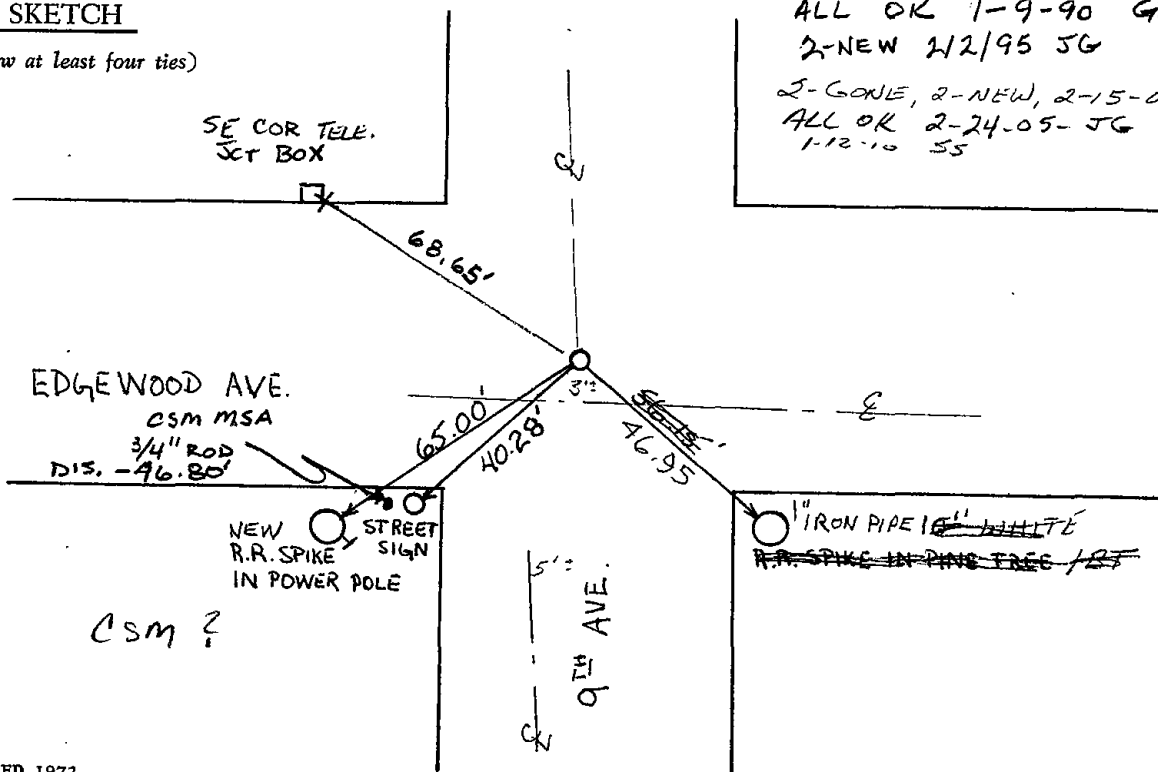

ALL OK 1-9-90 GR-KZ
2-NEW 2/2/95 JG
2-GONE, 2-NEW, 2-15-00, JG-SS
ALL OK 2-24-05-JG
1-12-10 SS