

## PUBLIC LAND SURVEY MONUMENT RECORD

TYPE OF MONUMENT: HARRISON (BROKEN-TOP)  
 ADAMS COUNTY COORDINATES, NAD 83 (2007)

N. 183201.020

E. 525906.504

ELEVATION- \_\_\_\_\_ DATUM \_\_\_\_\_

FIELD WORK DATE: 11/13/2017

### BASIS FOR MONUMENT LOCATION

1977 - PLS 1103 RAN EDM/T2 TRAVERSE AROUND SECTION 18-16-6 AND TO THE SOUTHEAST CORNER OF SECTION 12-16-5. THE WEST QUARTER CORNER OF 18-16-6 (ALSO THE EAST QUARTER CORNER OF 13-16-6) HAD BEEN PREVIOUSLY MONUMENTED BY DON PAULSON ON 7-26-1974, BUT SINCE THE SOUTHEAST CORNER OF SECTION 12 WAS PLACED IN IT'S PRESENT LOCATION, IT BECAME NECESSARY TO CHANGE THIS CORNER TOO. 1977 TIE SHEET REFLECTS THAT CHANGE, WITH THE CORNER BEING MONUMENTED BY SINGLE PROPORTIONATE MEASURE ON LINE BETWEEN ADJACENT CORNERS. COULD NOT FIND ANY EVIDENCE OF THE ORIGINAL CORNER. SET A HARRISON MONUMENT AND TIED OUT.

2017 - PLS 2994 FOUND A HARRISON MONUMENT WITH A BROKEN-TOP 6" BELOW THE GROUND SURFACE AND 1 TIE. THE MONUMENT AGREES WITH THE EXISTING TIE. ACCEPTED THE HARRISON MONUMENT AS THE CORNER LOCATION. SET 3 NEW TIES AND MEASURED TO THE TIES.

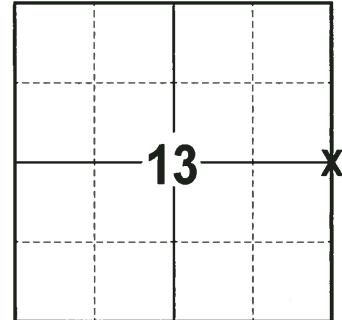

**LOCATION**  
 (INDICATE CORNER BY "X")

SEAL:



DATA SHOWN HERE ON THIS TIE SHEET IS CORRECT AND COMPLETE TO THE BEST OF MY KNOWLEDGE AND BELIEF.

PROFESSIONAL LAND SURVEYOR

DATE 12-4-17

### - TIE SKETCH

NOTE: THE CORNER FALLS 37'± SOUTH OF THE CENTERLINE OF EDGEWOOD DR.

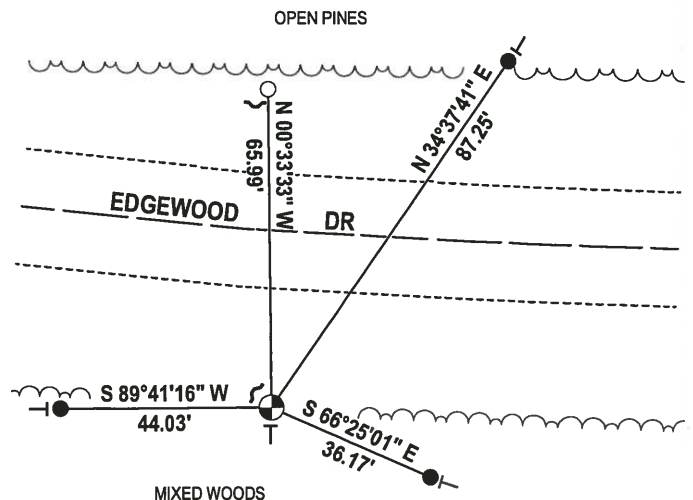
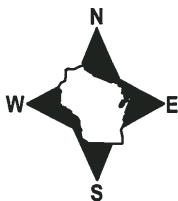

- 3/4" x 18" IRON REBAR SET, 1.50#/FT
- 1" O.D. IROD PIPE FOUND
- ⊕ HARRISON (BROKEN-TOP) FOUND
- ✓ STEEL FENCE POST
- ┌ VINYL "T" POST

**ADAMS COUNTY**

**Survey Monument Record**

TYPE OF MONUMENT: HARRISON

STATE PLANE COORDINATES: N \_\_\_\_\_

E \_\_\_\_\_

ELEVATION — M.S.L. DATUM: \_\_\_\_\_

THETA ANGLE: \_\_\_\_\_

FIELD BOOK: 38 PAGE 26

CORNER NO. 54  
 SECTION 18  
 TOWN 16  
 RANGE 6E

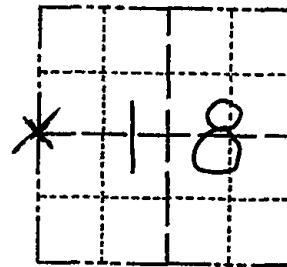

LOCATION  
(Indicated by 'X')

SEAL:

**BASIS FOR MONUMENT LOCATION**

(Use reverse side if necessary)

Show info such as: History of corner, with reference to Vol. and pg, dates, surveyor; exact description of monument replaced; if location computed, by taped or EDM traverse; landowner remarks, etc.



Ran EDM/T2 traverse around Section 18-16-6 and to the Southeast corner of Section 12-16-5.

The West Quarter corner of 18-16-6 (Also the East Quarter corner of 13-16-6) had been previously monumented by Don Paulson on 7-26-1974, but since the Southeast corner of Section 12 was placed in its present location, it became necessary to change this corner too.

This tie sheet reflects that change, with the corner being monumented by single proportionate measure on line between adjacent corners.

Could find no evidence of the original corner.

COR OK 10/20/80 KU SK  
 TOP BROKEN - BOTTOM IN PLACE 10-31-85 MB-SS  
 OK 1-9-90 GR-KZ  
 " 2-6-95 JG-GR

CERTIFIED CORRECT:  
Dale C. Hagen  
 Registered Land Surveyor  
 DATE: 2-9-77

**TIE SKETCH** ALL OK 5-17-00 - JG  
 1-GONE, 2-28-05 - JG  
 1-15-10, SS  
 (Show at least four ties)

**NOTE:**  
 Ties in trees to nail in disc.

