

ADAMS COUNTY

Survey Monument Record

TYPE OF MONUMENT: Standard Harrison

STATE PLANE COORDINATES: N \_\_\_\_\_

E \_\_\_\_\_

ELEVATION — M.S.L. DATUM: \_\_\_\_\_

THETA ANGLE: \_\_\_\_\_

FIELD BOOK: \_\_\_\_\_ PAGE \_\_\_\_\_

CORNER NO. 893 (71)

SECTION 13

TOWN 16

RANGE 6

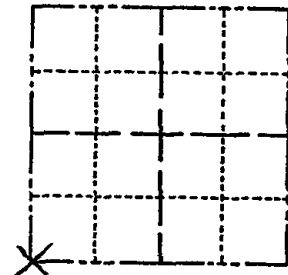

LOCATION  
(Indicated by 'X')

SEAL:

BASIS FOR MONUMENT LOCATION

(Use reverse side if necessary)

Show info such as: History of corner, with reference to Vol. and pg, dates, surveyor; exact description of monument replaced; if location computed, by taped or EDM traverse; landowner remarks, etc.

Ran EDM/transit traverse around Section 13 and to adjacent section corners.

Could find no evidence of the original corner or any evidence of remonumentation of the corner.

Set corner at record distance from North and East, thereby fitting adjacent physical evidence.

COR OK 10/15/80 KV-RN

ALL OK 7-15-85 OK.

OK 1-30-90 GR

4-22-93 MC SEE ATTACHED SHEET

ALL OK 1-23-95 JG-LR

1 NEW TIE 2-21-00 SS

ALL OK - 1-19-05, JG-DA

1-12-10 OK SS



CERTIFIED CORRECT:

*Dale C. Hagen*  
Registered Land Surveyor

DATE: January 28, 1976

TIE SKETCH

(Show at least four ties)

NOTE:

Ties in trees to nail in disc.

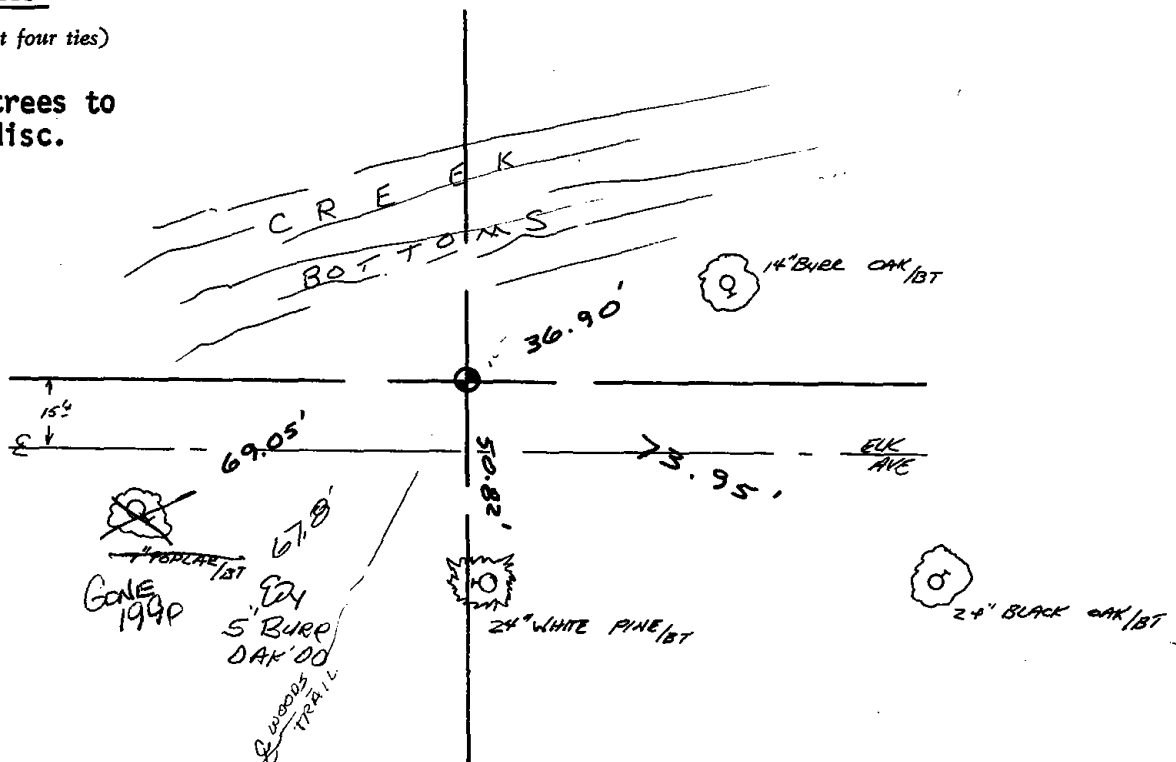

ADAMS COUNTY

Survey Monument Record

TYPE OF MONUMENT: Standard Harrison

STATE PLANE COORDINATES: N \_\_\_\_\_  
E \_\_\_\_\_

ELEVATION — M.S.L. DATUM: \_\_\_\_\_

THETA ANGLE: \_\_\_\_\_

FIELD BOOK: \_\_\_\_\_ PAGE \_\_\_\_\_

CORNER NO. 893 (71)

SECTION 13

TOWN 16

RANGE 6

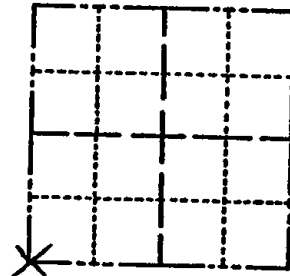

LOCATION  
(Indicated by 'X')

SEAL:

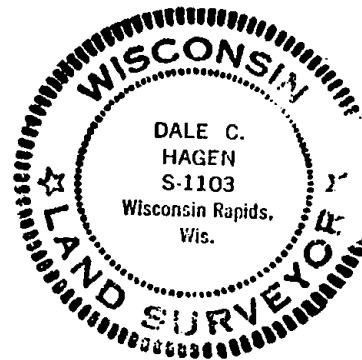

CERTIFIED CORRECT:

*Dale C. Hagen*  
Registered Land Surveyor

DATE: January 23, 1976

BASIS FOR MONUMENT LOCATION

(Use reverse side if necessary)

Show info such as: History of corner, with reference to Vol. and pg, dates, surveyor; exact description of monument replaced; if location computed, by taped or EDM traverse; landowner remarks, etc.

Ran EDM/transit traverse around Section 13 and to adjacent section corners.

Could find no evidence of the original corner or any evidence of remonumentation of the corner.

Set corner at record distance from North and East, thereby fitting adjacent physical evidence.

COR OK 10/15/80 KV-RN

ALL OK 7-15-85 OK.

OK 1-30-90 GR

~~OK 4-22-93 ME~~

TIE SKETCH

(Show at least four ties)

NOTE:

Ties in trees to nail in disc.

