

Government Land Corner Certificate

Adams County
 TYPE OF MONUMENT: Harrison REPLACED W/ 1" PIPE X 6'
 STATE PLANE COORDINATES: N _____
 E _____
 ELEVATION — M.S.L. DATUM: _____
 THETA ANGLE: _____
 FIELD BOOK: 86 PAGE 107
 DRAWN BY: T.H.

CORNER NO. 12
 SECTION 1
 TOWN 17
 RANGE 5

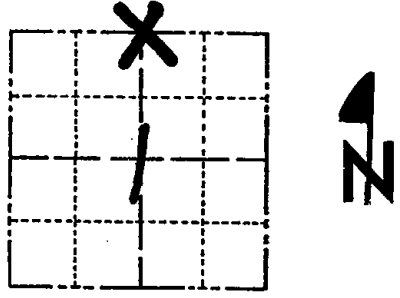

LOCATION
 (Indicated by 'X')

BASIS FOR MONUMENT LOCATION

Show info such as: History of corner, with reference to Vol. and pg., dates, surveyor; exact description of monument replaced; if location computed, by taped or EDM traverse; landowner remarks, etc. (Use reverse side if necessary)

No record of resurveys. Found no evidence of original post or BT's. Found an iron bar as show on the sktch, but did not accept it as the corner since we have no record of how it was set, and because it was more than 19' from being half way between corners. This being a town line and the other distances being close to originals, this ought to be also. Corner is set on line equidistant between section corners.

SEAL:



DATA SHOWN HERE ON
 CERTIFIED CORRECT:

Anthony B. Kiedrowski
 Registered Land Surveyor

DATE: 1/3/81

MAN. OK 2-NEW 8-24-90 SS-JG
 1-GONE ATIES LEFT 8-17-94 JG-SS
 REPLACED HAR. WITH 1" X 6' STEEL PIPE - NOW
 @ EDGE OF BANK 6-23-85 JG-SS

ALL TREES HAVE SIGNS - STEEL POST ON HIGH BANK 3'4' NORTH
TIE SKETCH

Show at least four ties, also fence lines, roads, topo, size and type of witness trees and if off road - best way to arrive at corner.

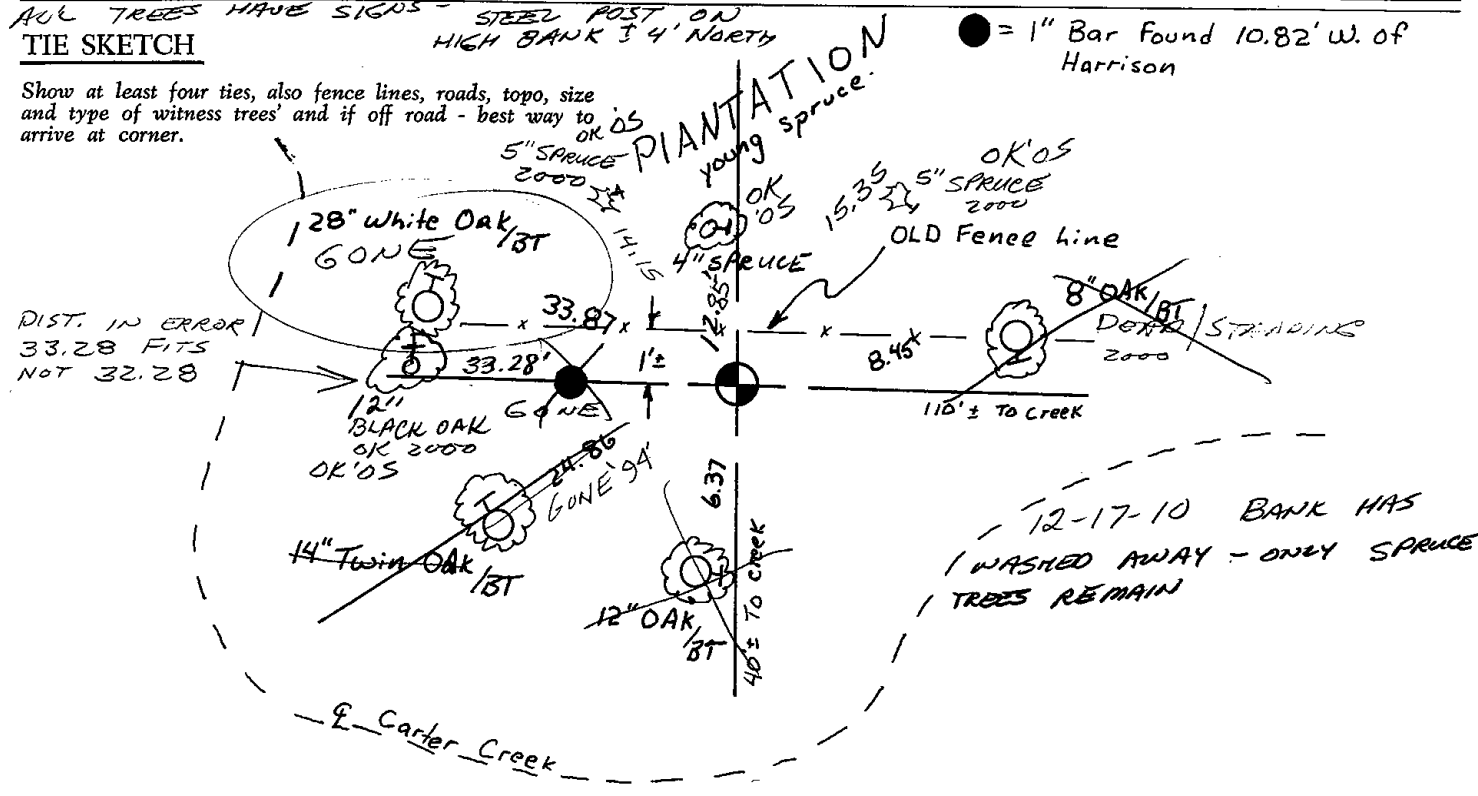

● = 1" Bar Found 10.82' W. of Harrison

12-17-10 BANK HAS
 1 WASHED AWAY - ONLY SPRUCE
 TREES REMAIN

Government Land Corner Certificate

ADAMS County

TYPE OF MONUMENT: HARRISON

STATE PLANE COORDINATES: N _____
E _____

ELEVATION — M.S.L. DATUM: _____

THETA ANGLE: _____

FIELD BOOK: 86 PAGE 107

DRAWN BY: S. J. S.

CORNER NO. 12

SECTION 1

TOWN 17

RANGE 5

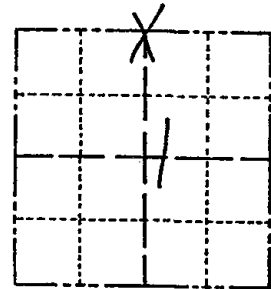

LOCATION
(Indicated by 'X')

SEAL:

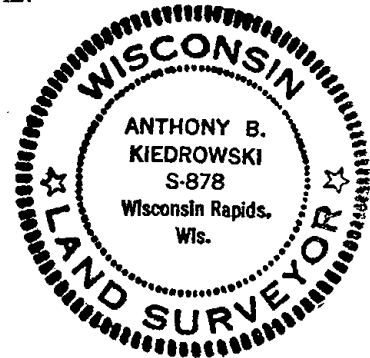

DATA SHOWN HERE ON
CERTIFIED CORRECT:

Anthony B. Kiedrowski
Registered Land Surveyor

DATE: 1-3-81

TIE SKETCH

Show at least four ties, also fence lines, roads, topo, size and type of witness trees' and if off road - best way to arrive at corner.

