

26 SECTION 17 TOWN 05 RANGE

ADAMS COUNTY

COUNTY CORNER NO: 99
 ROMPORTOL ID: 41705262000

PUBLIC LAND SURVEY MONUMENT RECORD

TYPE OF MONUMENT: HARRISON (BROKEN-TOP)
 ADAMS COUNTY COORDINATES, NAD 83 (2007)
 N. 200231.107
 E. 520543.334
 ELEVATION- - - - - DATUM - - - - -
 FIELD WORK DATE: 01/10/2019

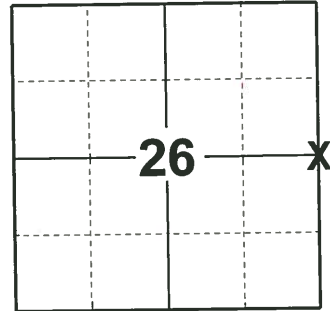

LOCATION

(INDICATE CORNER BY "X")

SEAL:



DATA SHOWN HERE ON THIS TIE SHEET IS CORRECT AND COMPLETE TO THE BEST OF MY KNOWLEDGE AND BELIEF.

PROFESSIONAL LAND SURVEYOR

DATE 3/12/19

BASIS FOR MONUMENT LOCATION

1976 - PLS-1103 RAN EDM/T2 TRAVERSE AROUND SECTIONS 25 AND 26, TYING INTO THE TRAVERSE ACROSS THE SOUTH SIDE OF THESE SECTIONS BY MIDSTATES, ASSOC. COULD FIND NO EVIDENCE OF THE ORIGINAL CORNER OR ANY REMONUMENTATION, THOUGH A DOWN FENCE CORNER WAS INDICATED BY HARRY WORMET, ADJACENT LAND OWNER, AS BEING APPROXIMATELY WHERE HE THOUGHT THE CORNER SHOULD BE. SET CORNER EQUIDISTANT AND ON LINE BETWEEN ADJACENT SECTION CORNERS.

2019 - PLS-2675 FOUND HARRISON MONUMENT (BROKEN-TOP) 6" BELOW THE WATER LINE, DID NOT RECOVER ANY TIES OR WITNESS. THE MONUMENT WAS VERIFIED TO BE ON A NEAR STRAIGHT LINE AND EQUIDISTANT BETWEEN THE NE AND SE CORNERS OF SECTION 26. ACCEPTED THE HARRISON MONUMENT (BROKEN-TOP) AS THE CORNER AND SET 4 NEW TIES.

- TIE SKETCH

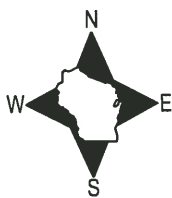

- SET 3/4" x 18" IRON REBAR, 1.50#/FT
- ⊕ FOUND HARRISON MONUMENT (BROKEN-TOP)
- ~ STEEL FENCE POST
- VINYL "T" POST

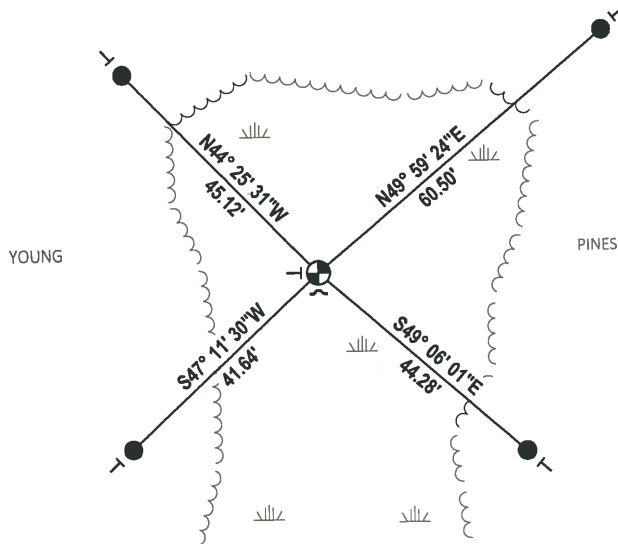

ADAMS COUNTY

Survey Monument Record

TYPE OF MONUMENT: Harrison

STATE PLANE COORDINATES: N _____

E _____

ELEVATION — M.S.L. DATUM: _____

THETA ANGLE: _____

FIELD BOOK: 37 PAGE 42

CORNER NO. 1022

SECTION 26

TOWN 17

RANGE 5

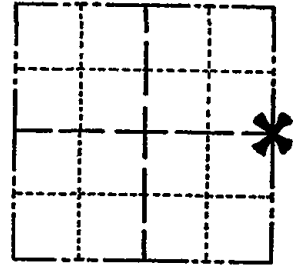

LOCATION
(Indicated by 'X')

SEAL:



BASIS FOR MONUMENT LOCATION

(Use reverse side if necessary)

Show info such as: History of corner, with reference to Vol. and pg, dates, surveyor; exact description of monument replaced; if location computed, by taped or EDM traverse; landowner remarks, etc.

Ran EDM/T2 traverse around Sections 25 and 26, tying into the traverse across the South side of these sections by Midstates, Assoc.

Could find no evidence of the original corner or any remonumentation, though a down fence corner was indicated by Harry Wormet, adjacent land owner, as being approximately where he thought the corner should be.

Set corner equidistant and on line between adjacent section corners.

Corner set 6-8-76.

CAN'T FIND. ENTIRE AREA IS NOW CORN FIELD. NO WAY OF KNOWING WHERE TO LOOK. CAN TURN ANGLE AND DISTANCE FROM NORTH. RN-SK 1/16/81

NO EVIDENCE FALL '85

CERTIFIED CORRECT:

Dale C. Hagen

Registered Land Surveyor

DATE: Sept. 20, 1976.

TIE SKETCH SEE SECTION SUMMARY DALE C. HAGEN 6-14-76 IN COUNTY SURVEY RECORDS 9-4-90 SS-JG

NOTE:

Ties in trees to nail in disc.

