

08 SECTION 17 TOWN 06 RANGE

ADAMS COUNTY

COUNTY CORNER NO: 44

ROMPORTOL ID: 41706080020

PUBLIC LAND SURVEY MONUMENT RECORD

TYPE OF MONUMENT: HARRISON
ADAMS COUNTY COORDINATES, NAD 83 (2007)

N. 213560.569

E. 533688.352

ELEVATION- DATUM

FIELD WORK DATE: 06/14/2017

BASIS FOR MONUMENT LOCATION

1974- PLS 1103 FOUND A 3/4" X 3" IRON BOLT ABOVE A 7"X8"X20" STONE THAT HAD BEEN TIPPED ON ITS SIDE. REPLACED WITH HARRISON MONUMENT.

2017 - PLS 2994 FOUND MAG NAIL IN ROADWAY, DUG DOWN AND FOUND HARRISON 10" BELOW THE SURFACE. FOUND 2 WITNESSES AS WELL. THE MONUMENT AGREES WITH THE EXISTING WITNESSES. ACCEPTED HARRISON AS CORNER LOCATION, SET 4 NEW TIES AND RE-MEASURED TO EXISTING TIES AND WITNESSES.

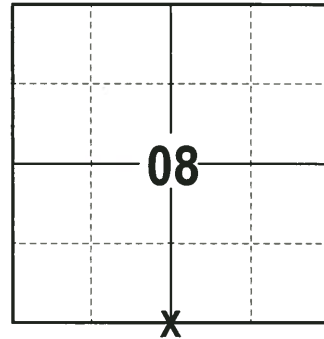

LOCATION
(INDICATE CORNER BY "X")

SEAL:



DATA SHOWN HERE ON THIS TIE SHEET IS CORRECT AND COMPLETE TO THE BEST OF MY KNOWLEDGE AND BELIEF.

PROFESSIONAL LAND SURVEYOR

DATE 6/26/17

- TIE SKETCH -

NOTE: THE CORNER FALLS 9± NORTH OF THE CENTERLINE OF CTH M.

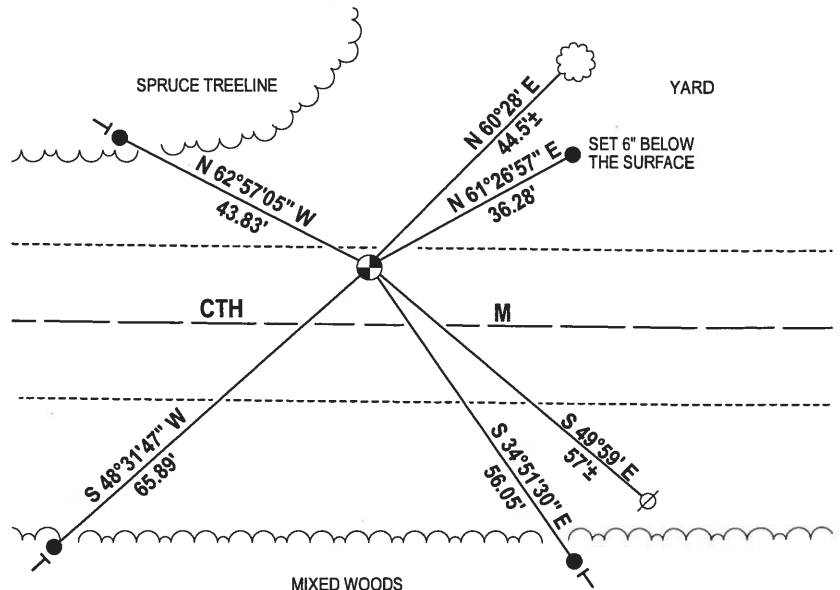
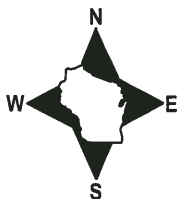

- 3/4" x 18" IRON REBAR SET, 1.50#/FT
- ⊕ HARRISON FOUND
- ⊗ WITNESS POWER POLE FOUND
- └ VINYL "T" POST
- ☁ WITNESS TREE FOUND

ADAMS COUNTY

CORNER NO. 366

Survey Monument Record

SECTION 17

TYPE OF MONUMENT: Standard Harrison

TOWN 17

STATE PLANE COORDINATES: N

RANGE 6

E

ELEVATION - M.S.L. DATUM:

THETA ANGLE:

FIELD BOOK: /// PAGE 4

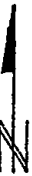
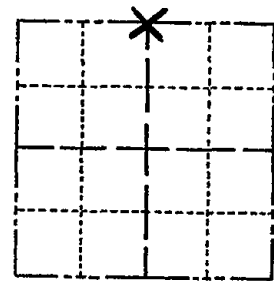

LOCATION (Indicated by 'X')

SEAL:

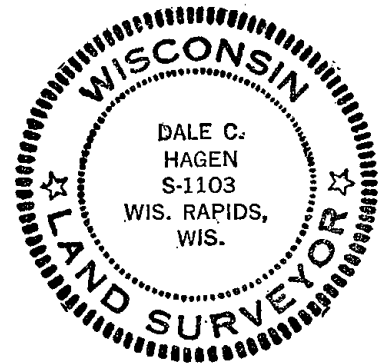

BASIS FOR MONUMENT LOCATION

(Use reverse side if necessary)

Show info such as: History of corner, with reference to Vol. and pg, dates, surveyor; exact description of monument replaced; if location computed, by taped or EDM traverse; landowner remarks, etc.

Found Iron bolt (3/4" by 3") above 7" by 8" by 20" Stone that had been tipped on its side. Replaced with Standard Harrison Monument.

Everything O.K. 10/10/75 J.M.-SS
MON BEEPS TIRS OK 3/6/80 RN-SS
OK 9-16-85 GR.
2-GONE-2-NEW 6-5-90 DC-JG
ALL OK 7-29-94 JG-BS
1-GONE, 1-NEW TIR, 2-10-00, JG-BS
OK 1-25-05-JG
FO MAG NAIL/TIES 1-26-10

CERTIFIED CORRECT:

Dale C. Hagen Registered Land Surveyor

DATE: April 24, 1974

TIE SKETCH

(Show at least four ties)

