

Government Land Corner Certificate

ADAMS County
 TYPE OF MONUMENT: HARRISON
 STATE PLANE COORDINATES: N _____
 E _____
 ELEVATION — M.S.L. DATUM: _____
 THETA ANGLE: _____
 FIELD BOOK: 83 PAGE 105
 DRAWN BY: PAUL KIEDROWSKI

CORNER NO. 2
 SECTION 6
 TOWN 17
 RANGE 7

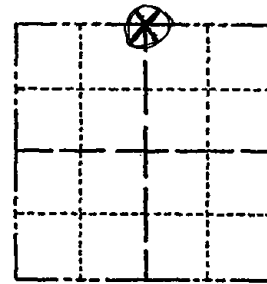

LOCATION
(Indicated by 'X')

SEAL:



DATA SHOWN HERE ON
CERTIFIED CORRECT:

Anthony B. Kiedrowski
Registered Land Surveyor

DATE: 6/9/80

BASIS FOR MONUMENT LOCATION

Show info such as: History of corner, with reference to Vol. and pg., dates, surveyor; exact description of monument replaced; if location computed, by taped or EDM traverse; landowner remarks, etc. (Use reverse side if necessary)

This corner was re-established after running an EDM traverse of section 5,6,7,8, and analyzing occupation, corners found, and comparing with original notes. No resurveys of record and no evidence of previous monumentation found.

Corner as set is on a straight line and in proportion to original notes.

TIE SKETCH

Show at least four ties, also fence lines, roads, topo, size and type of witness trees and if off road - best way to arrive at corner.

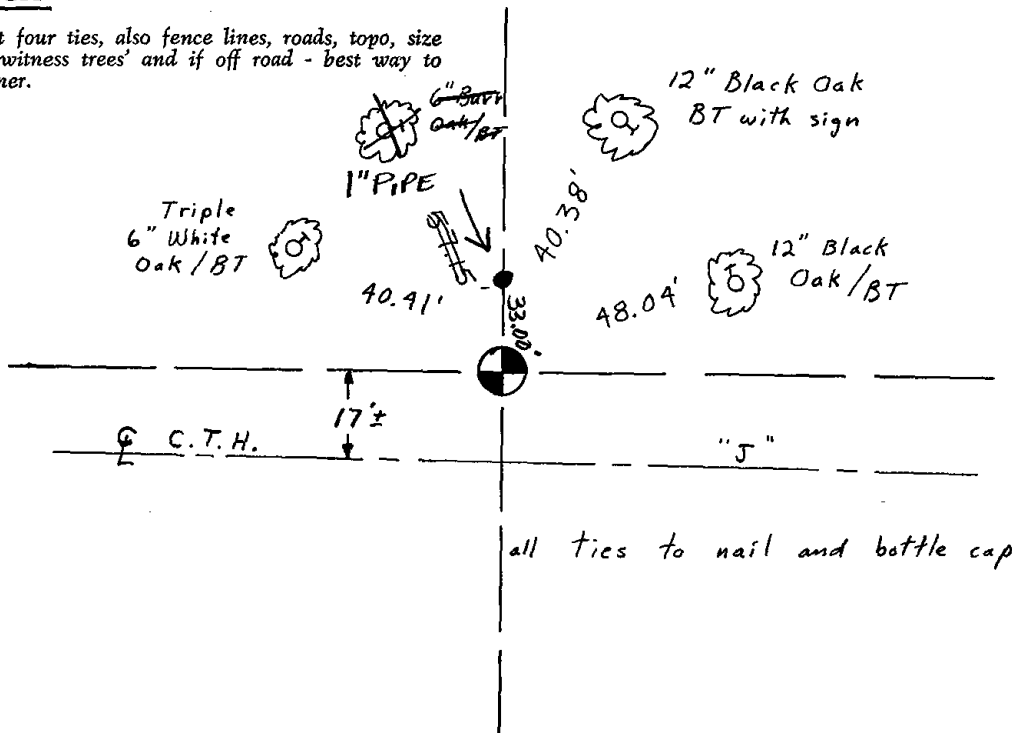

all ties to nail and bottle cap

