

31 SECTION 18 TOWN 07 RANGE

ADAMS COUNTY

COUNTY CORNER NO: 122

ROMPORTOL ID: 41807310020

PUBLIC LAND SURVEY MONUMENT RECORD

TYPE OF MONUMENT: HARRISON
ADAMS COUNTY COORDINATES, NAD 83 (2007)

N. 224417.695

E. 559764.465

ELEVATION- DATUM

FIELD WORK DATE: 01/09/2018

BASIS FOR MONUMENT LOCATION

2017 - PLS 2994 NO TIE SHEET ON RECORD. FOUND A HARRISON MONUMENT 18" BELOW THE ROAD SURFACE. VERIFIED THE CORNER LOCATION FROM THE DISTANCES ON CSM NO. 5018, DOC. NO. 458050. THE MONUMENT AGREES WITH THE WITH THE DISTANCES ON CSM AND TO THE SW AND SE CORNERS ON SECTION 31. ACCEPTED THE HARRISON MONUMENT AS THE CORNER LOCATION. SET 4 NEW TIES AND MEASURED TO THE TIES.

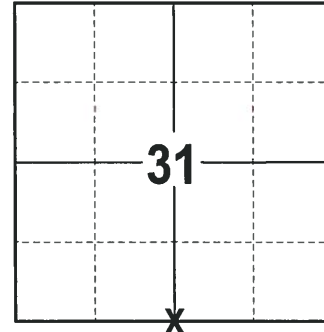

LOCATION
(INDICATE CORNER BY "X")

SEAL:

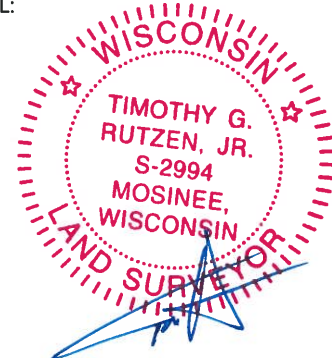

DATA SHOWN HERE ON THIS TIE SHEET IS CORRECT AND COMPLETE TO THE BEST OF MY KNOWLEDGE AND BELIEF.

PROFESSIONAL LAND SURVEYOR

DATE 2-2-18

- TIE SKETCH -

NOTE: THE CORNER FALLS 20'± NORTH OF THE CENTERLINE OF CTH J.

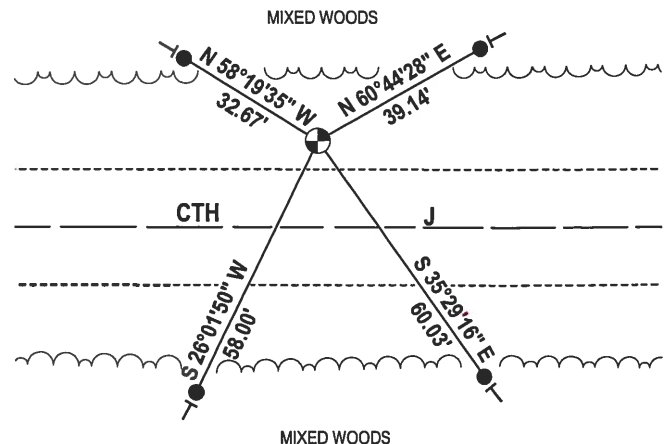
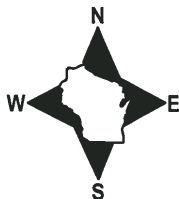

- 3/4" x 18" IRON REBAR SET, 1.50#/FT
- ⊕ HARRISON FOUND
- VINYL "T" POST

Government Land Corner Certificate

122

ADAMS County
 TYPE OF MONUMENT: HARRISON
 STATE PLANE COORDINATES: N _____
 E _____
 ELEVATION — M.S.L. DATUM: _____
 THETA ANGLE: _____
 FIELD BOOK: 83 PAGE 105
 DRAWN BY: PAUL KIEDROWSKI

CORNER NO. 2
 SECTION 6
 TOWN 17
 RANGE 7

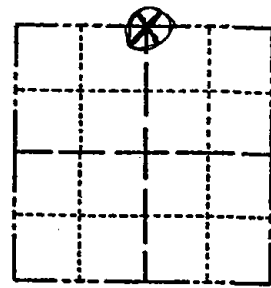

LOCATION
(Indicated by 'X')

BASIS FOR MONUMENT LOCATION

Show info such as: History of corner, with reference to Vol. and pg., dates, surveyor; exact description of monument replaced; if location computed, by taped or EDM traverse; landowner remarks, etc. (Use reverse side if necessary)

This corner was re-established after running an EDM traverse of section 5,6,7,8, and analyzing occupation, corners found, and comparing with original notes. No resurveys of record and no evidence of previous monumentation found.

Corner as set is on a straight line and in proportion to original notes.

OK 1-08-02 - JG
 1-GONE, 1-NEW, 4-10-07-JG

SEAL:



DATA SHOWN HERE ON CERTIFIED CORRECT:

Anthony B. Kiedrowski
 Registered Land Surveyor

DATE: 6/9/80

TIE SKETCH

Show at least four ties, also fence lines, roads, topo, size and type of witness trees' and if off road - best way to arrive at corner.

