

25 SECTION    18 TOWN    04 RANGE

# ADAMS COUNTY

COUNTY CORNER NO: 112A

ROMPORTOL ID: 41804250020A

## PUBLIC LAND SURVEY MONUMENT RECORD

TYPE OF MONUMENT: M.C. ALUMINUM CAP IN CONCRETE (MEANDER CORNER)

ADAMS COUNTY COORDINATES, NAD 83 (2007)

N. 229492.351

E. 493802.725

ELEVATION- \_\_\_\_\_ DATUM \_\_\_\_\_

FIELD WORK DATE: 01/17/2019

### BASIS FOR MONUMENT LOCATION

1981 - PLS-1167 FOUND MEANDER MONUMENT SET BY M.C. SMITH WITH HIS INITIALS ON IT. ACCEPTED AS SECTION LINE AND TIED IN SAME.

2019 - PLS-2675 FOUND M.C. ALUMINUM CAP IN CONCRETE (MEANDER CORNER) 5" ABOVE GROUND, 2 WITNESS TREES, AND CONCRETE SLAB WITNESS. MONUMENT AGREES WITH ALL WITNESSES. ACCEPTED M.C. ALUMINUM CAP IN CONCRETE (MEANDER CORNER) AS THE CORNER. SET 4 NEW TIES AND MEASURED TO ALL WITNESSES.



**LOCATION**

(INDICATE CORNER BY "X")

SEAL:

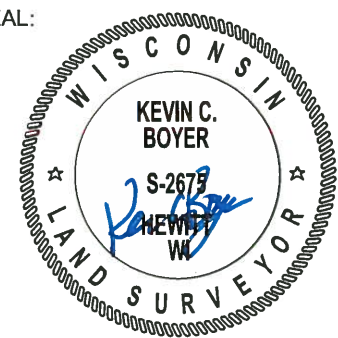

DATA SHOWN HERE ON THIS TIE SHEET IS CORRECT AND COMPLETE TO THE BEST OF MY KNOWLEDGE AND BELIEF.

PROFESSIONAL LAND SURVEYOR

DATE 3/12/19

### - TIE SKETCH

NOTE: THE CORNER LANDS UNDER EAST-WEST FENCE AND 6'± EAST OF FENCE CORNER

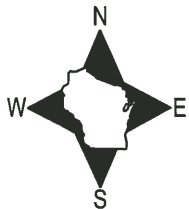

- SET 3/4" x 18" IRON REBAR, 1.50#/FT
- ⊙ FOUND M.C. ALUMINUM CAP IN CONCRETE (MEANDER CORNER)
- ┆ VINYL "T" POST
- ☁ WITNESS TREE

