

084

ADAMS COUNTY

Survey Monument Record

TYPE OF MONUMENT: 30" Harrison standard  
 STATE PLANE COORDINATES: N \_\_\_\_\_ E \_\_\_\_\_  
 ELEVATION — M.S.L. DATUM: \_\_\_\_\_  
 THETA ANGLE: \_\_\_\_\_  
 FIELD BOOK: \_\_\_\_\_ PAGE \_\_\_\_\_

BASIS FOR MONUMENT LOCATION

(Use reverse side if necessary)

Show info such as: History of corner, with reference to Vol. and pg. dates, surveyor; exact description of monument replaced; if location computed, by taped or EDM traverse; landowner remarks, etc.

Set equidistant and on line between adjacent section corners.

- OK 7-18-78 PK-SS
- " 3-4-83 SS
- " 2-12-88 GR-SS
- " 7-28-92 JG-BS
- OK 2-2-98 - JG

TIE SKETCH

(Show at least four ties)

• = 3/4" ROD SET BY J.G.V. 4-11-88  
 (SEE ATTACHED PAGE)

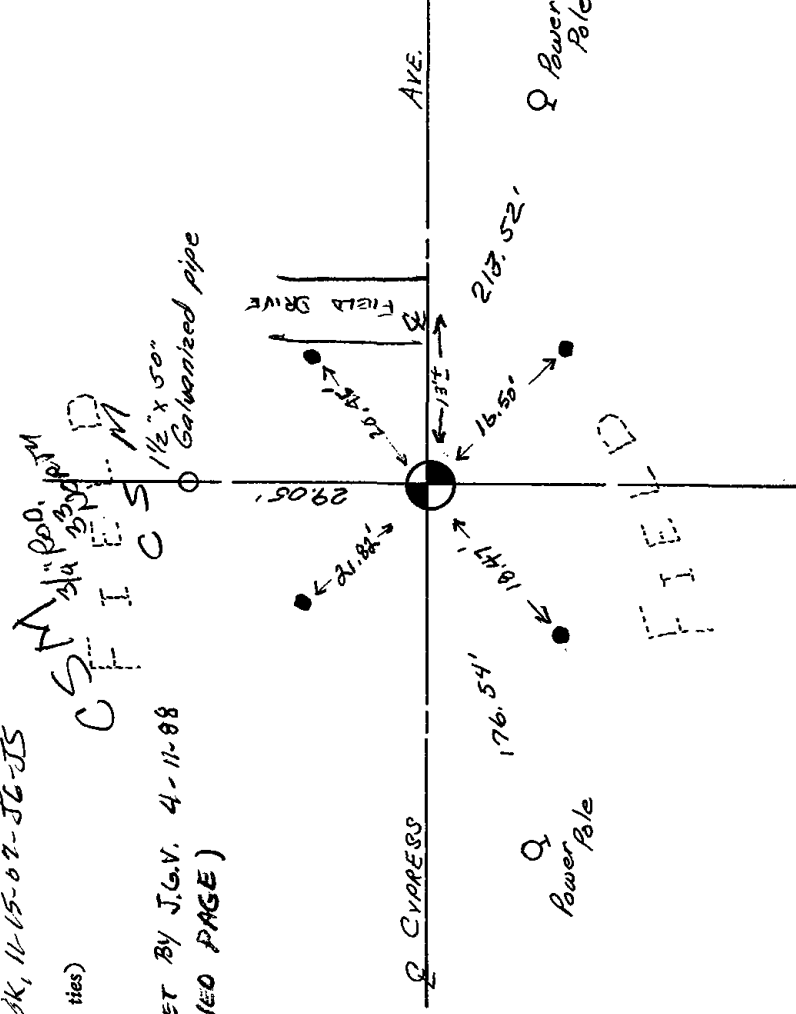

CF I E S  
 1/4" ROD  
 3/4" ROD  
 1 1/2" x 50" Galvanized pipe

CORNER NO. 560  
 SECTION 29  
 TOWN 18  
 RANGE 6

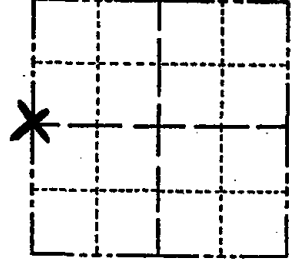

LOCATION (Indicated by 'X')

SEAL:

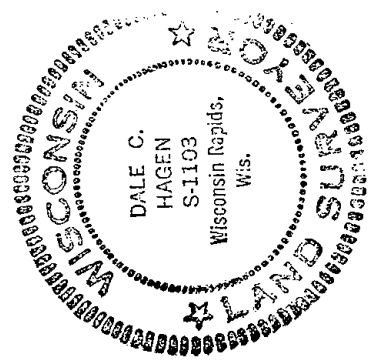

CERTIFIED CORRECT:

Dale C. Hagen  
 Registered Land Surveyor

DATE: 10-28-74

OK-12-2-02 SS

U. S. PUBLIC LAND SURVEY MONUMENT RECORD

ADAMS COUNTY

INSTRUCTIONS: This record shall show the location of the corner and shall include all of the following nine elements (a through i).

- (a) Identify the corner by reference to the U. S. public land survey system.
- = Corner monument restored.

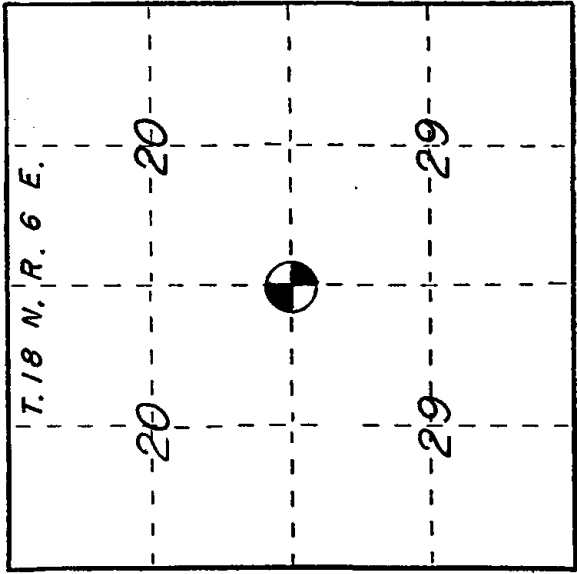



*W 1/4 CORNER  
SECTION 29  
T18N R6E  
TOWN OF PRESTON  
ADAMS Co., Wis*

- (b) Describe any record evidence, monument evidence, occupational evidence, testimonial evidence, or any other material evidence you considered, and whether the monument was found or placed.

*FOUND AMERISON MON. AND SET NEW  
TIES AS STAWN BELOW.*

- (c) In the plan view drawing below, provide reference ties to at least 4 witness monuments, or, if the location is within a municipality, to at least 2 witness monuments. (Witness monuments shall be made of concrete, natural stone, iron or other equally durable material.) Describe witness monuments.

- (d) Show a plan view drawing depicting the relevant monuments and reference ties which is sufficient in detail to enable accurate relocation of the corner monument if the corner monument is disturbed. Indicate north.

 ADAMS CO. MONUMENT FD.  
 3/4" X 24" REBAR SET

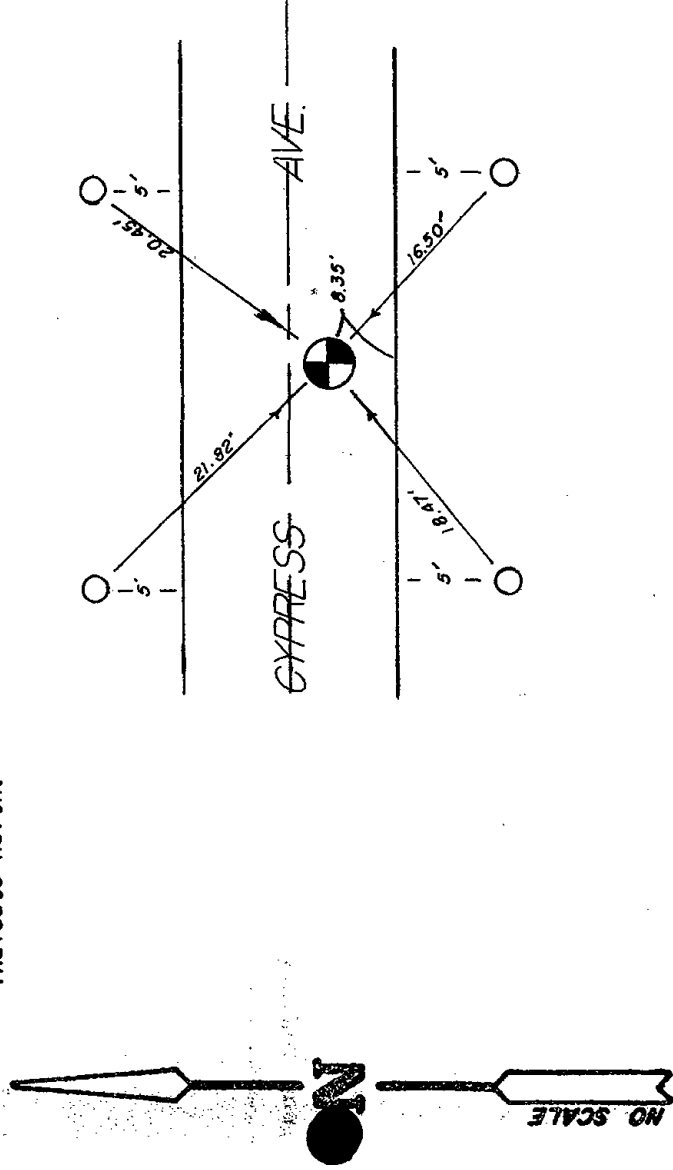

(e) Describe any material discrepancy between the location of the corner as restored or reestablished and the location of that corner as previously restored or reestablished by distance and direction. Show the discrepancy on the plan view drawing under (d), above. Show the distances between the corner as previously restored or reestablished and (1) the corner as restored or reestablished, and (2) to at least 2 of the witness monuments shown on the drawing in (d), above.

NONE

(f) Was the corner restored through acceptance of (1) an obliterated evidence location, or, (2) a found perpetuated location?

(g&h) Was the corner reestablished through lost corner proportionate methods? If so, show the method, including the directions and distances to other public land survey corners used as evidence or used for proportioning in determining the corner location?

NO

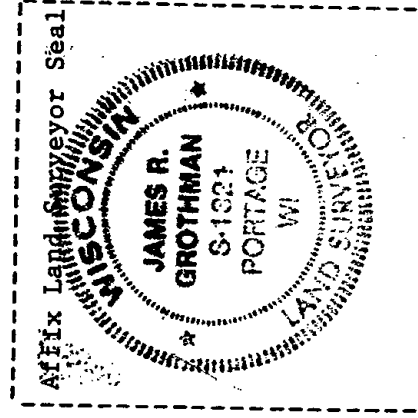

(i) I, JAMES R. GROTHMAN (type or print name) certify that the corner location shown on this record was determined by me or under my direction and control and that this U.S. Public Land Survey Monument Record is correct and complete to the best of my knowledge and belief.

James R. Grothman Signature      9/15/88 Date



083



U. S. PUBLIC LAND SURVEY MONUMENT RECORD

ADAMS COUNTY

INSTRUCTIONS:

This record shall show the location of the corner and shall include all of the following nine elements (a through i).

- (a) Identify the corner by reference to the U.S. public land survey system.
- = Corner monument restored.

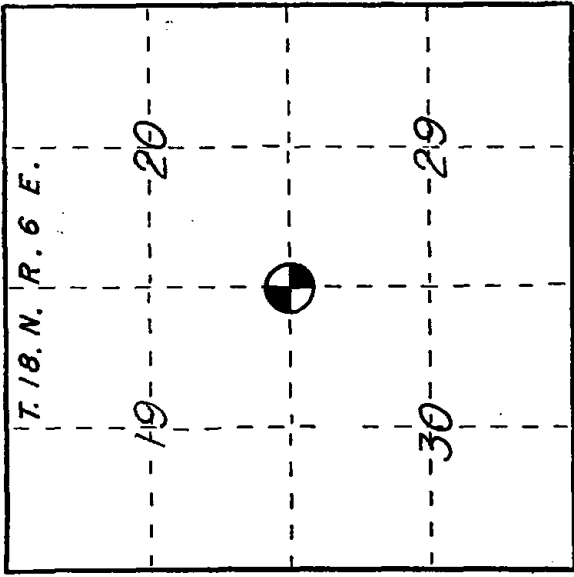

NW CORNER  
SECTION 29  
T18N R6E  
TOWN OF PRESTON  
ADAMS Co., WI

- (b) Describe any record evidence, monument evidence, occupational evidence, testimonial evidence, or any other material evidence you considered, and whether the monument was found or placed.

FOUND HARRISON MAN. AND SET  
NEW TIES AS SHOWN BELOW.

- (c) In the plan view drawing below, provide reference ties to at least 4 witness monuments, or, if the location is within a municipality, to at least 2 witness monuments. (Witness monuments shall be made of concrete, natural stone, iron or other equally durable material.) Describe witness monuments.

- (d) Show a plan view drawing depicting the relevant monuments and reference ties which is sufficient in detail to enable accurate relocation of the corner monument if the corner monument is disturbed. Indicate north.

○ ● ADAMS CO. MONUMENT FD.  
○ 3/4" X 24" REBAR SET

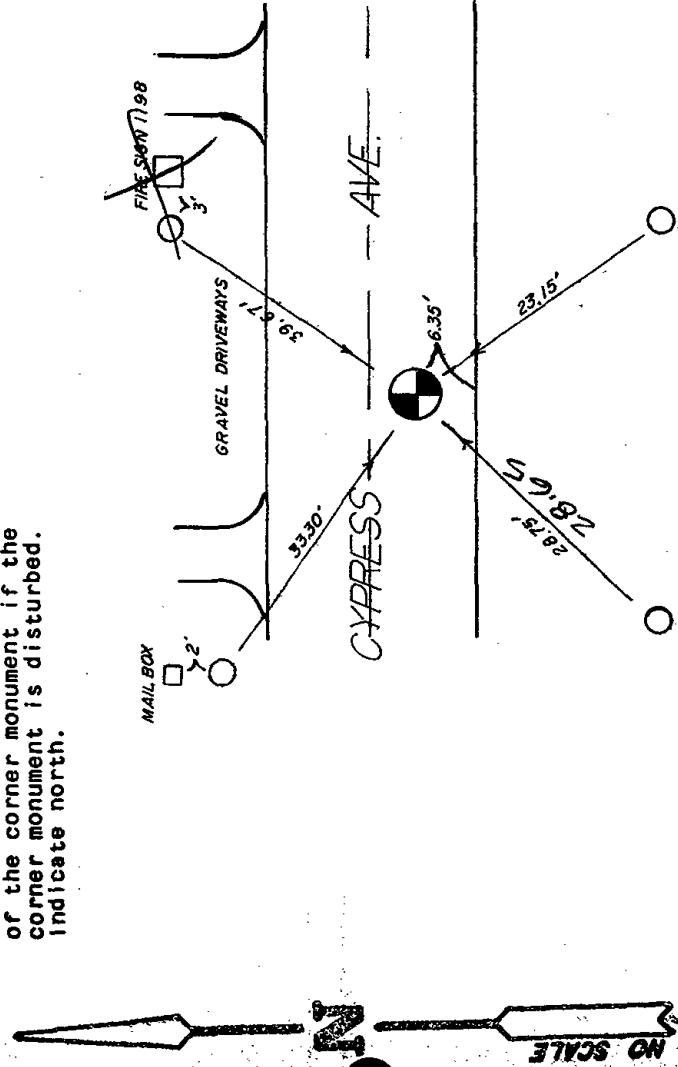

(e) Describe any material discrepancy between the location of the corner as restored or reestablished and the location of that corner as previously restored or reestablished by distance and direction. Show the discrepancy on the plan view drawing under (d), above. Show the distances between the corner as previously restored or reestablished and (1) the corner as restored or reestablished, and (2) to at least 2 of the witness monuments shown on the drawing in (d), above.

NONE

(f) Was the corner restored through acceptance of (1) an obliterated evidence location, or, (2) a found perpetuated location?

(g&h) Was the corner reestablished through lost corner proportionate methods? If so, show the method, including the directions and distances to other public land survey corners used as evidence or used for proportioning in determining the corner location?

NO

(i) I, James R. Grotzman (type or print name) certify that the corner location shown on this record was determined by me or under my direction and control and that this U.S. Public Land Survey Monument Record is correct and complete to the best of my knowledge and belief.

James R. Grotzman Signature

9/15/88 Date

Affix Land Surveyor Seal







# U. S. PUBLIC LAND SURVEY MONUMENT RECORD

## ADAMS COUNTY

**I N S T R U C T I O N S :**

This record shall show the location of the corner and shall include all of the following nine elements (a through i).

(a) Identify the corner by reference to the U.S. public land survey system.

○ = Corner monument restored.

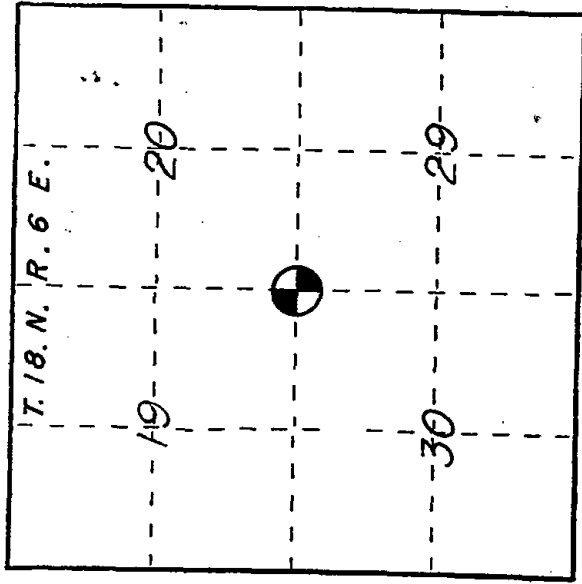

NW CORNER  
SECTION 29  
T18N R6E  
TOWN OF PRESTON  
ADAMS Co., WI

(b) Describe any record evidence, monument evidence, monument evidence, occupational evidence, testimonial evidence or any other material evidence you considered, and whether the monument was found or placed.

FOUND HARRISON MAN. AND SET  
NEW TIES AS SHOWN BELOW.

(c) In the plan view drawing below, provide reference ties to at least 4 witness monuments, or, if the location is within a municipality, to at least 2 witness monuments. (Witness monuments shall be made of concrete, natural stone, iron or other equally durable material.) Describe witness monuments.

(d) Show a plan view drawing depicting the relevant monuments and reference ties which is sufficient in detail to enable accurate relocation of the corner monument if the corner monument is disturbed. Indicate north.

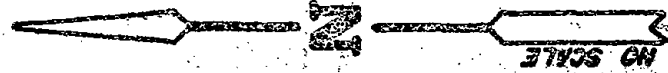
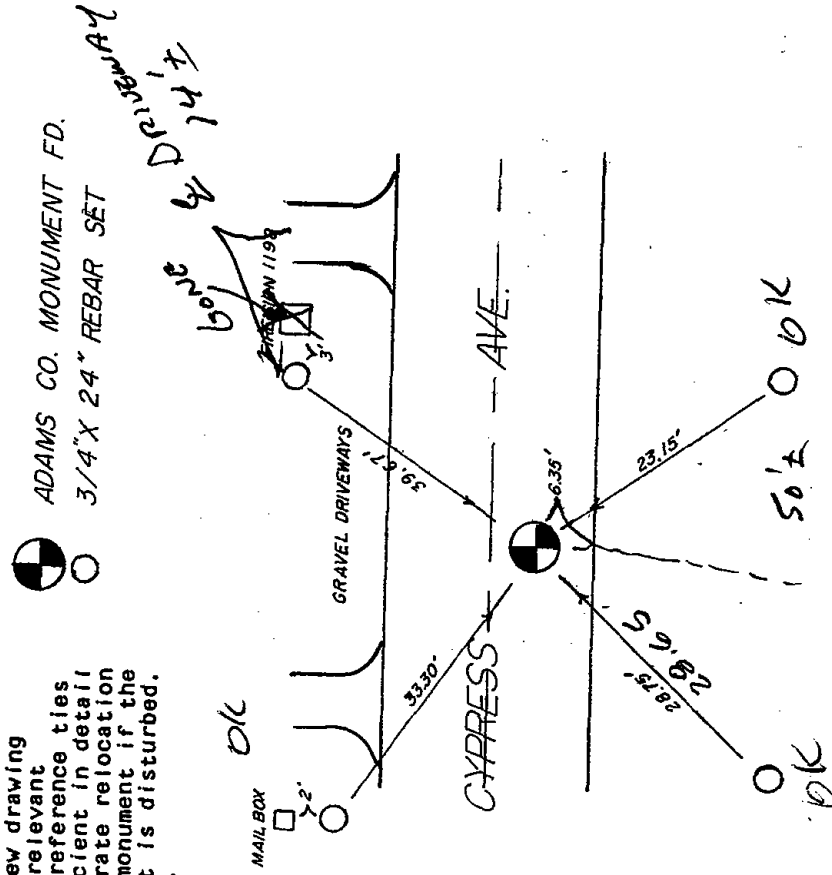

HARRISON MAN. 40"  
BACHMANN