

PUBLIC LAND SURVEY MONUMENT RECORD

TYPE OF MONUMENT: HARRISON (BROKEN TOP)
 ADAMS COUNTY COORDINATES, NAD 83 (2007)

N. 321817.990

E. 517563.113

ELEVATION- DATUM

FIELD WORK DATE: 12/14/2016

BASIS FOR MONUMENT LOCATION

1973 - PLS 878 FOUND NO EVIDENCE OF THE CORNER. RETRACED THE SURVEY OF FORMER COUNTY SURVEYOR PHILLIPS THAT WAS DONE FOR THE TUTTLES AND SET A HARRISON.

2017 - PLS 2994 FOUND EXISTING HARRISON WITH A BROKEN TOP FLUSH WITH THE SURFACE, TWO WITNESS TREES AND 5 TIES. THE HARRISON AGREES WITH THE EXISTING TREE AND TIES. ACCEPTED HARRISON AND MEASURED TO EXISTING IRONS.

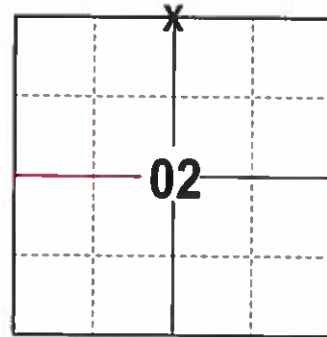

LOCATION
 (INDICATE CORNER BY "X")

SEAL:

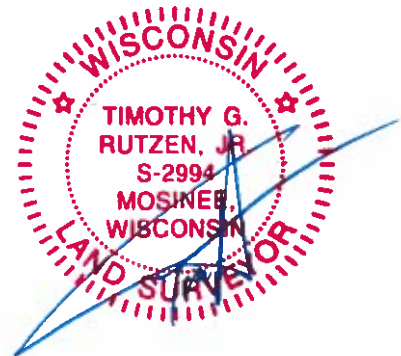

DATA SHOWN HERE ON THIS TIE SHEET IS CORRECT AND COMPLETE TO THE BEST OF MY KNOWLEDGE AND BELIEF.

PROFESSIONAL LAND SURVEYOR

DATE 2/9/17

- TIE SKETCH

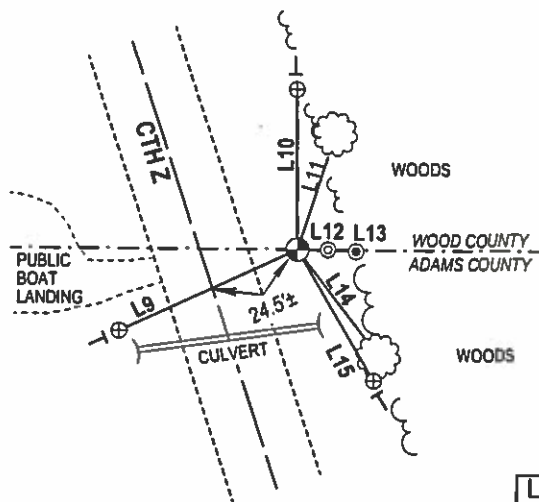
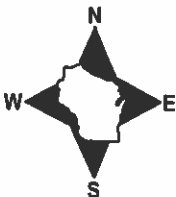

- ⊕ 7/8" REBAR FOUND
- ⊙ 3/4" REBAR FOUND
- ⊙ 1" OD IRON PIPE FOUND
- ⊙ HARRISON FOUND
- ⊖ VINYL "T" POST
- ☁ FOUND WITNESS TREE

LINE	BEARING	DISTANCE
L9	S 65°20'45" W	51.10'
L10	N 00°26'33" W	41.56'
L11	N 18°07' E	31.5±
L12	N 89°59'34" E	8.03'
L13	S 88°33'59" E	15.27'
L14	S 37°43' E	35±
L15	S 30°34'29" E	39.49'

ADAMS COUNTY
Survey Monument Record

CORNER NO. 307
 SECTION 2
 TOWN 20
 RANGE 5

TYPE OF MONUMENT: 30" HARRISON
 STATE PLANE COORDINATES: N _____
 E _____
 ELEVATION — M.S.L. DATUM: _____
 THETA ANGLE: _____
 FIELD BOOK: 108 PAGE 21

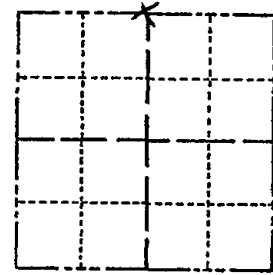

LOCATION
 (Indicated by 'X')

SEAL:



BASIS FOR MONUMENT LOCATION

(Use reverse side if necessary)

Show info such as: History of corner, with reference to Vol. and pg, dates, surveyor; exact description of monument replaced; if location computed, by taped or EDM traverse; landowner remarks, etc.

Set by a retracement of a survey that former County Surveyor Phillips did for the Tuttles.

No evidence of the corner itself.

CERTIFIED CORRECT:

Anthony B. Kiedrowski
 Registered Land Surveyor
 DATE: 9/18/73

HARRISON BROOK 11-5-79 55-55
 Ok- 3-20-84 G-S
 " ADD 1-22-84 55
 2-NEW TIES 3-4-94 JG-55

TIE SKETCH 2-GONE, 2-NEW TIES 2-16-99- JG-55

(Show at least four ties)

OK 1-13-09 55

