

PUBLIC LAND SURVEY MONUMENT RECORD

TYPE OF MONUMENT: HARRISON
ADAMS COUNTY COORDINATES, NAD 83 (2007)

N. 290414.931

E. 557149.818

ELEVATION- --- DATUM ---

FIELD WORK DATE: 02/05/2018

BASIS FOR MONUMENT LOCATION

1977 - PLS 1103 RAN EDM/T2 TRAVERSE AROUND SECTIONS 36, 25 & PORTIONS OF ADJOINING SECTIONS TO DETERMINE THE SEARCH AREA FOR INVESTIGATION. INVESTIGATION YIELDED A 1"X30" IRON PIPE WITHIN THE SEARCH AREA, BUT WAS UNABLE TO FIND ANY EVIDENCE OF THE ORIGINAL CORNER OR ANY BEARING TREES. RE-MONUMENTED THE IRON PIPE WITH A HARRISON MONUMENT ON 11-9-1977, AND RE-SET THE IRON PIPE 8-1/2± NORTH OF THE HARRISON AND TIED OUT.

2018 - PLS 2994 FOUND A HARRISON MONUMENT FLUSH WITH THE GROUND SURFACE AND 2 WITNESS TREES. THE MONUMENT AGREES WITH THE EXISTING WITNESS TREES. ACCEPTED THE HARRISON MONUMENT AS THE CORNER LOCATION. SET 4 NEW TIES AND MEASURED TO THE TIES AND WITNESS TREES.

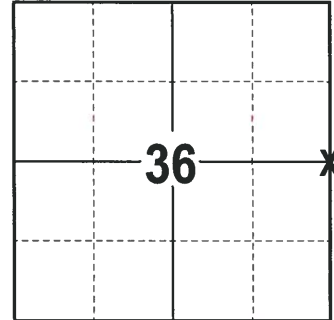

LOCATION
(INDICATE CORNER BY "X")

SEAL:

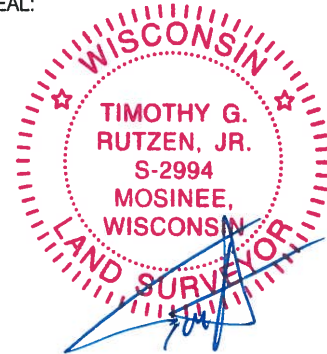

DATA SHOWN HERE ON THIS TIE SHEET IS CORRECT AND COMPLETE TO THE BEST OF MY KNOWLEDGE AND BELIEF.

PROFESSIONAL LAND SURVEYOR

DATE 3-1-18

- TIE SKETCH

NOTE: THE CORNER FALLS 30± EAST OF THE TRAIL.

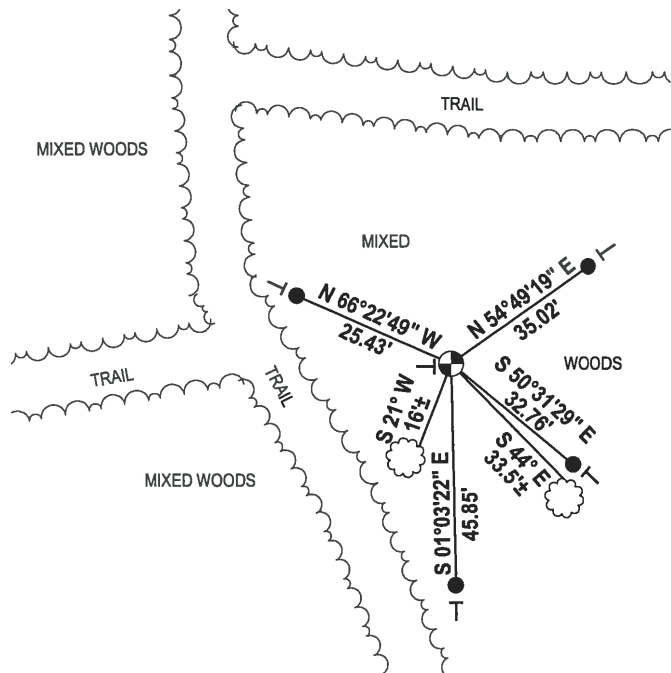
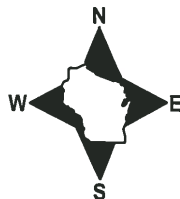

- 3/4" x 18" IRON REBAR SET, 1.50#/FT
- ⊙ HARRISON FOUND
- └ VINYL "T" POST

Government Land Corner Certificate

ADAMS County
 TYPE OF MONUMENT: HARRISON STD.
 STATE PLANE COORDINATES: N _____
 E _____
 ELEVATION — M.S.L. DATUM: _____
 THETA ANGLE: _____
 FIELD BOOK: 57 PAGE 38
 DRAWN BY: SCOTT SORENSEN

CORNER NO. 120
 SECTION 36
 TOWN 20
 RANGE 6

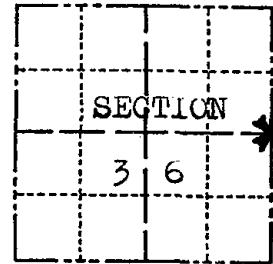

LOCATION
(Indicated by 'X')

BASIS FOR MONUMENT LOCATION

Show info such as: History of corner, with reference to Vol. and pg., dates, surveyor; exact description of monument replaced; if location computed, by taped or EDM traverse; landowner remarks, etc. (Use reverse side if necessary)

Ran EDM/T2 traverse around Sections 36, 25 & portions of adjoining sections to determine search area for investigation.

Investigation yielded a 1"x30" Iron Pipe within the search area, but was unable to find any evidence of the original corner or any bearing trees.

Re-monumented Iron Pipe with Harrison Monument on 11-9-1977, and reset pipe $\frac{1}{2}$ " North of monument.

1 gone 4-27-84 DK-SS

SEAL:



DATA SHOWN HERE ON
CERTIFIED CORRECT:

Dale C. Hagen
Registered Land Surveyor

DATE: January 3, 1978

TIE SKETCH

Show at least four ties, also fence lines, roads, topo, size and type of witness trees' and if off road - best way to arrive at corner.

NOTE

Ties in trees to nail in disc.

FO, STEEL POST
ADJACENT 2010

MAINTENANCE RECORD

Date	Init.	Remarks
7-13-79	RN-RW	OK
2-27-89	SS	ADD 2 TIES
6-13-84	CR-JG	OK
4-9-99	JG-SS	OK
01-07-10	SS	OK

